



US006134058A

United States Patent [19]

[11] Patent Number: **6,134,058**

Mohri et al.

[45] Date of Patent: **Oct. 17, 2000**

[54] **OBJECT LENS DRIVING DEVICE**

62-119742	6/1987	Japan .
64-82341	3/1989	Japan .
2-23536	1/1990	Japan .
4-103042	4/1992	Japan .
4-366429	12/1992	Japan .
5-10249	3/1993	Japan .
5-16647	5/1993	Japan .
6-68844	8/1994	Japan .
9-22537	1/1997	Japan .

[75] Inventors: **Masanari Mohri**, Hyogo; **Hitoshi Fujii**, Osaka; **Kanji Wakabayashi**; **Hiroshi Yamamoto**, both of Kyoto; **Teruyuki Takizawa**; **Takeo Santo**, both of Osaka, all of Japan

[73] Assignee: **Matsushita Electric Industrial Co., Ltd.**, Osaka, Japan

Primary Examiner—Georgia Epps
Assistant Examiner—Saud Seyrafi
Attorney, Agent, or Firm—Ratner & Prestia

[21] Appl. No.: **09/342,585**

[22] Filed: **Jun. 29, 1999**

[57] **ABSTRACT**

[30] **Foreign Application Priority Data**

Jul. 3, 1998	[JP]	Japan	10-188650
Oct. 20, 1998	[JP]	Japan	10-298051

[51] **Int. Cl.⁷** **G02B 7/02; G11B 7/00**

[52] **U.S. Cl.** **359/824; 359/813; 359/814; 369/44.15**

[58] **Field of Search** **359/811, 813, 359/814, 819, 823, 824; 369/44.15, 44.16**

An object lens driving device of the present invention includes a movable section, supporting sections for supporting the movable section and a base for holding the supporting sections. The movable section includes an object lens for recording and/or reproducing optical information to and/or from a disk-shaped recording medium, a lens holder for holding the object lens and at least four permanent magnets adhered to the lens holder. The supporting sections include at least four metal wires substantially parallel to each other, each wire having a first end fixed to the lens holder and a second end connected to the base, and elastic deformable elements connected to the base and having connecting sections thereof connected to the second end of each respective metal wire. The base includes yokes fixed to the base and facing the respective permanent magnets, focusing coils wound around the respective yokes, wound axes of the focusing coils being oriented in a direction of an optical axis of the object lens, and tracking coils wound around the respective yokes, wound axes of the tracking coils being oriented in a direction perpendicular to the wound axes of the focusing coils.

[56] **References Cited**

U.S. PATENT DOCUMENTS

4,773,055	9/1988	Gijzen et al.	369/44.16
5,446,721	8/1995	Sekimoto et al.	369/247
5,905,255	5/1999	Wakabayashi et al.	250/201.5
6,016,292	1/2000	Lee	369/44.15

FOREIGN PATENT DOCUMENTS

58-88841	5/1983	Japan .
60-142822	9/1985	Japan .
61-187134	8/1986	Japan .
62-33345	2/1987	Japan .
62-33346	2/1987	Japan .

15 Claims, 17 Drawing Sheets

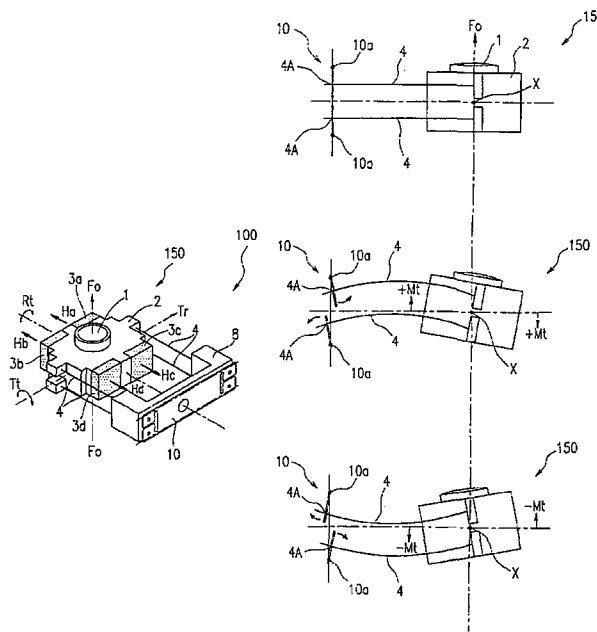

LG Electronics, Inc. et al.
EXHIBIT 1006

FIG. 1A

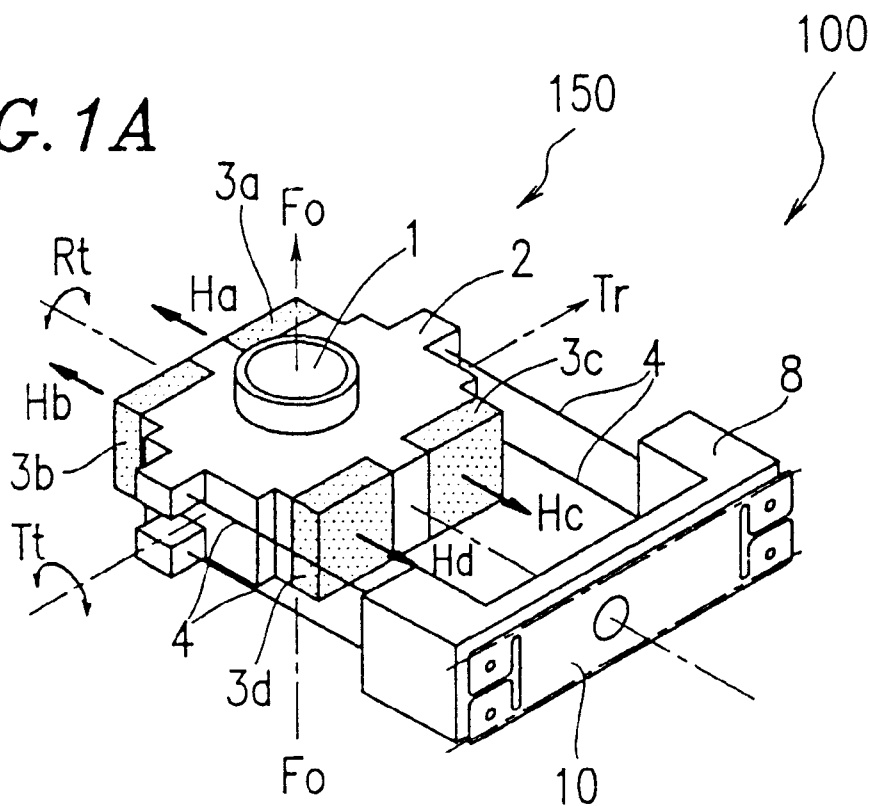

FIG. 1B

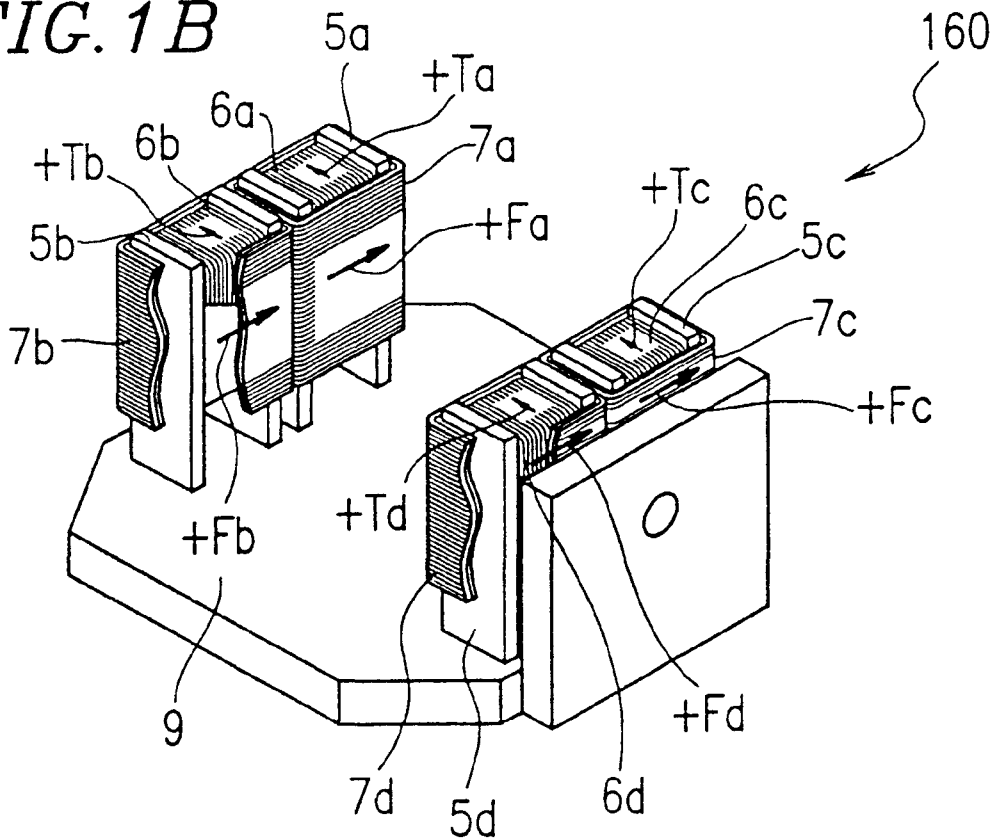

FIG. 2A

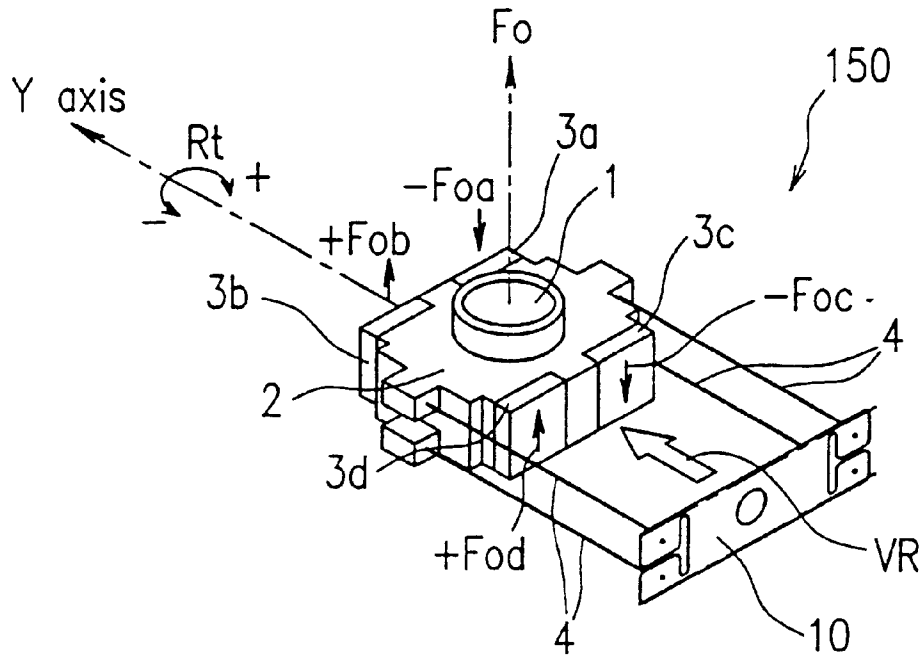

FIG. 2B

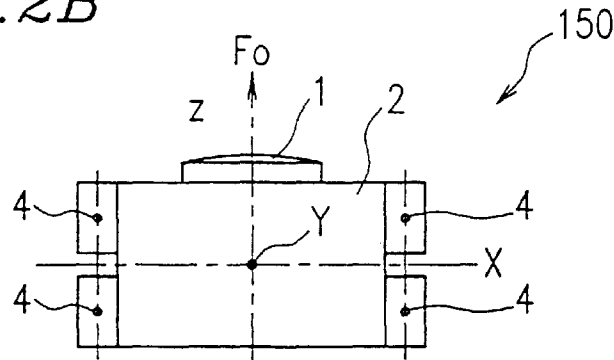

FIG. 2C

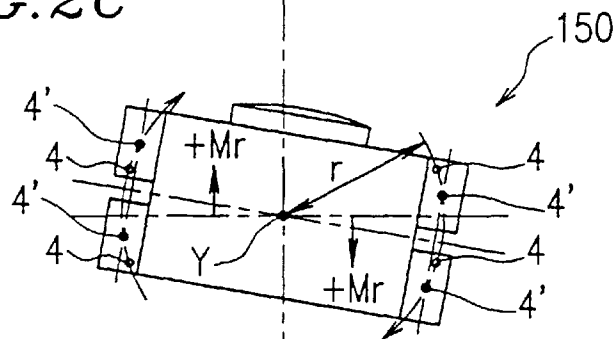

FIG. 2D

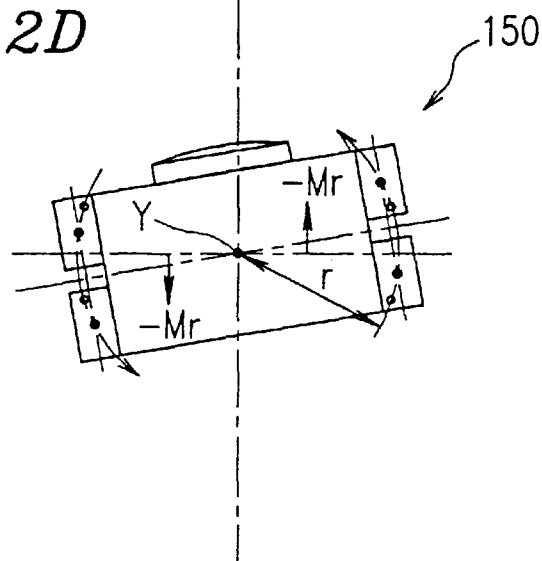
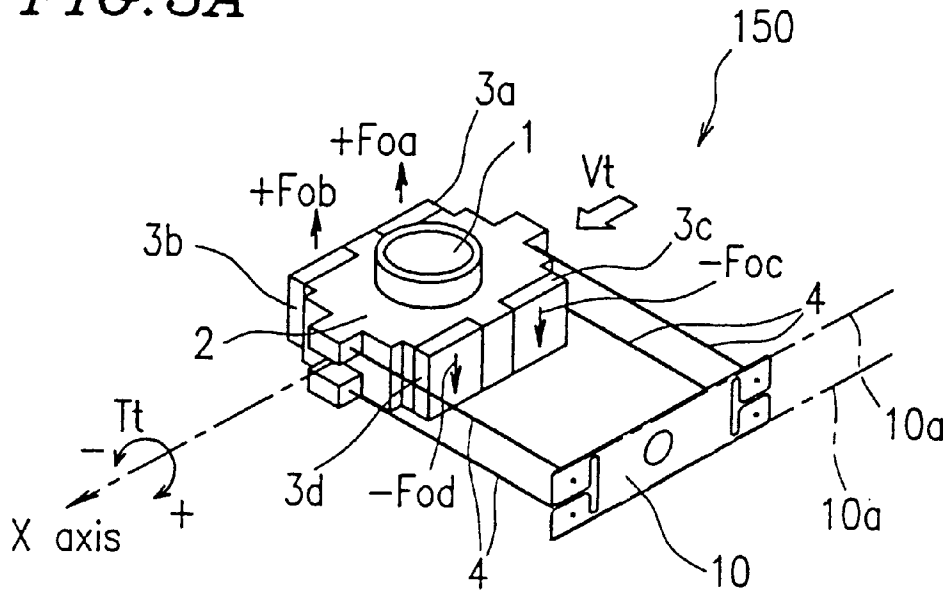

FIG. 3A



Explore Litigation Insights

Docket Alarm provides insights to develop a more informed litigation strategy and the peace of mind of knowing you're on top of things.

Real-Time Litigation Alerts



Keep your litigation team up-to-date with **real-time alerts** and advanced team management tools built for the enterprise, all while greatly reducing PACER spend.

Our comprehensive service means we can handle Federal, State, and Administrative courts across the country.

Advanced Docket Research



With over 230 million records, Docket Alarm's cloud-native docket research platform finds what other services can't. Coverage includes Federal, State, plus PTAB, TTAB, ITC and NLRB decisions, all in one place.

Identify arguments that have been successful in the past with full text, pinpoint searching. Link to case law cited within any court document via Fastcase.

Analytics At Your Fingertips



Learn what happened the last time a particular judge, opposing counsel or company faced cases similar to yours.

Advanced out-of-the-box PTAB and TTAB analytics are always at your fingertips.

API

Docket Alarm offers a powerful API (application programming interface) to developers that want to integrate case filings into their apps.

LAW FIRMS

Build custom dashboards for your attorneys and clients with live data direct from the court.

Automate many repetitive legal tasks like conflict checks, document management, and marketing.

FINANCIAL INSTITUTIONS

Litigation and bankruptcy checks for companies and debtors.

E-DISCOVERY AND LEGAL VENDORS

Sync your system to PACER to automate legal marketing.