

TM2107

**PARTS MANUAL
FOR
UC-6E,EC,ECM
MOTORIZED
COMBO SQUARED CARRIER
PART NUMBERS
210000-01,02,03**

© 2002

Image Capture Technologies (I.C.T.)

10231 A Trademark St. Rancho Cucamonga, Ca. 91730

Ph (909) 945-5106

Fax (909) 948-3788

Parts Manual Drawing and Bill of Materials Conventions

All Lowest Replaceable Units (LRUs) are identified to facilitate ordering the proper assembly or part for replacement. On the drawings, the "circled" numbers (those surrounded by a circle) and the "boxed" numbers (those surrounded by a box) correspond to the item number on the accompanying parts list, or "bill of materials".

The "circled" numbers on the drawings indicate the LRU. This is the Lowest Replaceable Unit, or assembly that can be purchased. Although assembly drawings for "circled" items do not exist, the "bill of materials" is included.

The "boxed" numbers on the drawings indicate that there is additional detail provided at a lower assembly level. Determine the "boxed" number corresponding to the assembly desired, and then locate the assembly drawing for more detail.

| Assembly | | Assembly Description | | Rev | U/M | | | | |
|-----------|----------------------------------|---|-----|--------------|-----|----------|----------|-----|----------|
| 210000-01 | | MOTORIZED COMBO SQUARED CARRIER UC-6E (MINOLTA) | | A | EA | | | | |
| Item | Component | Component Description | Rev | Qty Per Assy | U/M | Obs Date | Eff Date | ISC | Lot Size |
| 1 | 201001-05 | ASSY, SUPPLY UC-6E (SINGLE BALL SPINDLE) | A | 1.00000 | EA | | | P | 1 |
| 3 | 206002-02 | ASSY, TAKEUP UC-6E | A | 1.00000 | EA | | | P | 1 |
| 5 | 201003-08 | ASSY, FICHE UC-6E | A | 1.00000 | EA | | | P | 1 |
| 7 | 201051-08 | ASSY, BOTTOM TRAYS UC-6E MINOLTA | A | 1.00000 | EA | | | P | 1 |
| 11 | 210008-02 | ASSY, CABLE UC-6E MAIN | D | 1.00000 | EA | | | B | 1 |
| 13 | 201008-09 | ASSY, SHIPPING CONTAINER UC-6E | | 1.00000 | EA | | | P | 1 |
| 19 | 210012 | DECAL, "UC-6E" | | 1.00000 | EA | | | F | 1 |
| 22 | <u>PC0041</u> | PWR SUPPLY, SWITCHING 100-240VAC-24VDC @2.7A (2.5X5.5MM END) | | 1.00000 | EA | | | B | 1 |
| 25 | 210010 | BRACKET, TAKEUP UC-6E | B | 1.00000 | EA | | | B | 1 |
| 31 | RO0025 | REEL, TAKE UP | | 1.00000 | EA | | | B | 1 |
| 32 | SC0382 | SCREW PANHD 4-40X5/16 CRS | | 2.00000 | EA | | | F | 1 |
| | <i>Component Assembly Notes:</i> | | | | | | | | |
| | | X ITEM 11 | | | | | | | |
| 33 | SC0434 | SCREW, PANHD 10-32X1/4 FINE THREAD CRS | | 4.00000 | EA | | | B | 1 |
| | <i>Component Assembly Notes:</i> | | | | | | | | |
| | | X ITEM 1,3 | | | | | | | |
| 34 | WS0012 | WASHER LOCK INTERNAL STAR #4 STAINLESS STEEL | | 2.00000 | EA | | | F | 1 |
| | <i>Component Assembly Notes:</i> | | | | | | | | |
| | | X ITEM 11 | | | | | | | |
| 35 | NT0061 | NUT HEX 6-32 SMALL PATTERN STEEL ZINC | | 4.00000 | EA | | | F | 1 |
| | <i>Component Assembly Notes:</i> | | | | | | | | |
| | | X ITEM 7,11 | | | | | | | |
| 37 | AD0007 | THREADLOCKER ADHESIVE #222 | | 0.02000 | FO | | | F | 1 |
| | <i>Component Assembly Notes:</i> | | | | | | | | |
| | | X ITEM 39,41 | | | | | | | |
| 39 | KB0027 | KNOB, CAP BLACK, UC-6 | | 1.00000 | EA | | | B | 1 |
| 41 | KB0030 | KNOB, BLACK | | 1.00000 | EA | | | B | 1 |
| 43 | SC0071 | SCREW PANHEAD 6-32X3/8 CORROSION RESISTANT STEEL | | 2.00000 | EA | | | F | 1 |
| | <i>Component Assembly Notes:</i> | | | | | | | | |
| | | X ITEM 3 | | | | | | | |
| 45 | CH0034 | CABLE HOLDER - ALUMINUM | | 10.00000 | EA | | | F | 1 |
| | <i>Component Assembly Notes:</i> | | | | | | | | |
| | | X ITEM 11 | | | | | | | |
| 60 | TM1231 | MANUAL, USERS UC-6 | | 1.00000 | EA | | | B | 1 |
| 65 | TM2102 | MANUAL, UC-6E FILM LOADING AND BROWSE INSTRUCTIONS | | 1.00000 | EA | | | B | 1 |

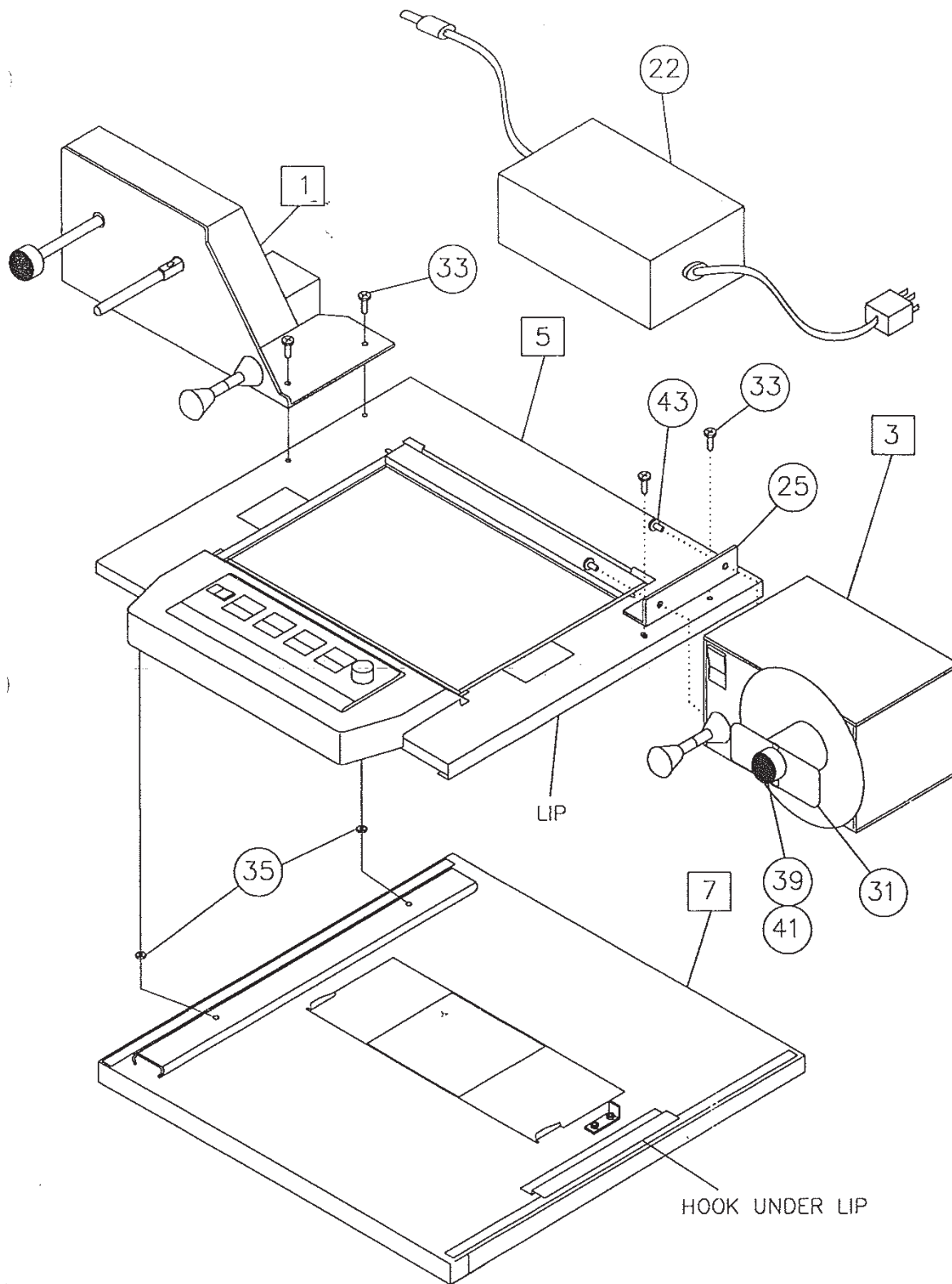

MOTORIZED COMBO SQUARED CARRIERS
 UC-6E 210000-01, UC-6EC 210000-02, UC-6ECM 210000-03

03/08/2002

Bill Of Materials

10:33:56 AM

| Assembly | Assembly Description | Rev | U/M |
|-----------|---|-----|-----|
| 210000-02 | MOTORIZED COMBO SQUARED CARRIER UC-6EC (CANON) | A | EA |

| Item | Component | Component Description | Rev | Qty Per Assy | U/M | Obs Date | Eff Date | ISC | Lot Size |
|------|-----------|--------------------------------|-----|--------------|-----|----------|----------|-----|----------|
| 70 | 210055-02 | LABEL, UC-6EC SERIAL NUMBER | | 1.00000 | EA | | | F | 1 |

Explore Litigation Insights

Docket Alarm provides insights to develop a more informed litigation strategy and the peace of mind of knowing you're on top of things.

Real-Time Litigation Alerts



Keep your litigation team up-to-date with **real-time alerts** and advanced team management tools built for the enterprise, all while greatly reducing PACER spend.

Our comprehensive service means we can handle Federal, State, and Administrative courts across the country.

Advanced Docket Research



With over 230 million records, Docket Alarm's cloud-native docket research platform finds what other services can't. Coverage includes Federal, State, plus PTAB, TTAB, ITC and NLRB decisions, all in one place.

Identify arguments that have been successful in the past with full text, pinpoint searching. Link to case law cited within any court document via Fastcase.

Analytics At Your Fingertips



Learn what happened the last time a particular judge, opposing counsel or company faced cases similar to yours.

Advanced out-of-the-box PTAB and TTAB analytics are always at your fingertips.

API

Docket Alarm offers a powerful API (application programming interface) to developers that want to integrate case filings into their apps.

LAW FIRMS

Build custom dashboards for your attorneys and clients with live data direct from the court.

Automate many repetitive legal tasks like conflict checks, document management, and marketing.

FINANCIAL INSTITUTIONS

Litigation and bankruptcy checks for companies and debtors.

E-DISCOVERY AND LEGAL VENDORS

Sync your system to PACER to automate legal marketing.