



US007585140B1

(12) **United States Patent**  
**Howes et al.**

(10) **Patent No.:** **US 7,585,140 B1**  
(45) **Date of Patent:** **Sep. 8, 2009**

(54) **VEHICLE AND CARGO TRANSPORT  
RATCHETING TIE DOWN APPARATUS AND  
SYSTEM**

(75) Inventors: **Philip Bryan Howes**, Braselton, GA  
(US); **Neil H. M. Robertson**,  
Lawrenceville, GA (US); **David  
Trenbeath**, Buford, GA (US)

(73) Assignee: **Cottrell, Inc.**, Gainesville, GA (US)

(\* ) Notice: Subject to any disclaimer, the term of this  
patent is extended or adjusted under 35  
U.S.C. 154(b) by 0 days.

(21) Appl. No.: **12/056,594**

(22) Filed: **Mar. 27, 2008**

(51) **Int. Cl.**  
**B60P 7/08** (2006.01)

(52) **U.S. Cl.** ..... **410/103; 410/12**

(58) **Field of Classification Search** ..... 410/7,  
410/9-12, 19, 21-23, 97, 100, 103; 254/217,  
254/223, 243, 247, 245, 330, 241, 345, 346,  
254/352, 355, 356, 357, 365, 369, 376; 248/499  
See application file for complete search history.

(56) **References Cited**

U.S. PATENT DOCUMENTS

4,382,736 A \* 5/1983 Thomas ..... 410/104  
5,101,537 A 4/1992 Cummings  
2006/0013667 A1 1/2006 Ruan

\* cited by examiner

*Primary Examiner*—Stephen Gordon

(74) *Attorney, Agent, or Firm*—Cantor Colburn LLP

(57) **ABSTRACT**

A ratcheting tie down apparatus and system. Exemplary  
embodiments include a ratcheting tie down system, including  
a ratchet assembly affixed to an end of a tie down shaft having  
a longitudinal axis, a pawl mechanism coupled to the ratchet  
assembly, wherein the ratchet assembly includes a ratchet  
gear, a ratchet head coupled to the ratchet gear, wherein an  
inner face of the ratchet gear is positioned in opposition to and  
in mechanical contact with an inner face of the ratchet head,  
and wherein the ratchet gear, the ratchet head and the shaft are  
configured to rotate as a single integral unit when rotated in a  
forward direction about the longitudinal axis, and the ratchet  
head is configured to rotate with respect to the ratchet gear  
and the shaft when the ratchet head is rotated in a reverse  
direction about the longitudinal axis.

**8 Claims, 11 Drawing Sheets**

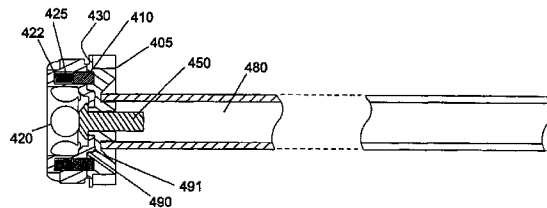
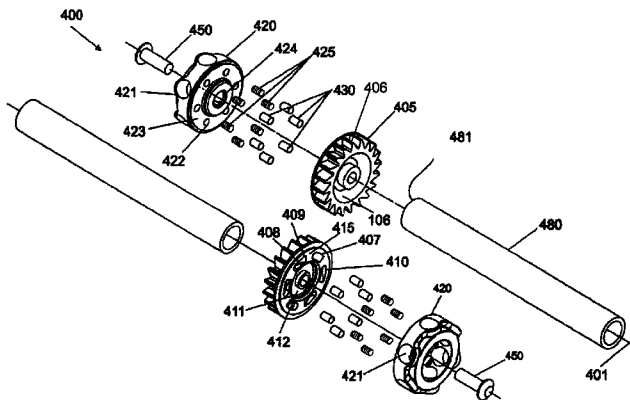

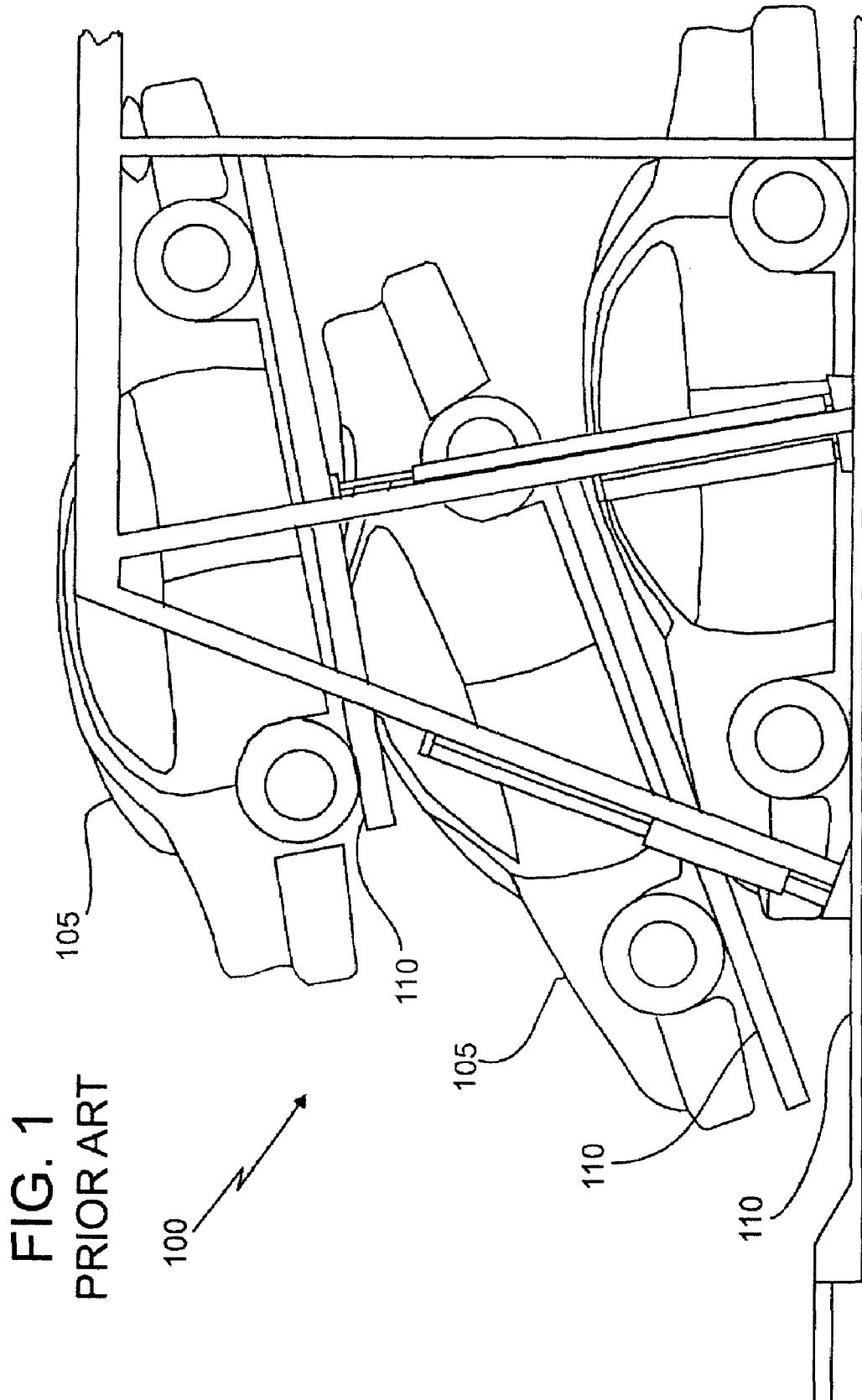
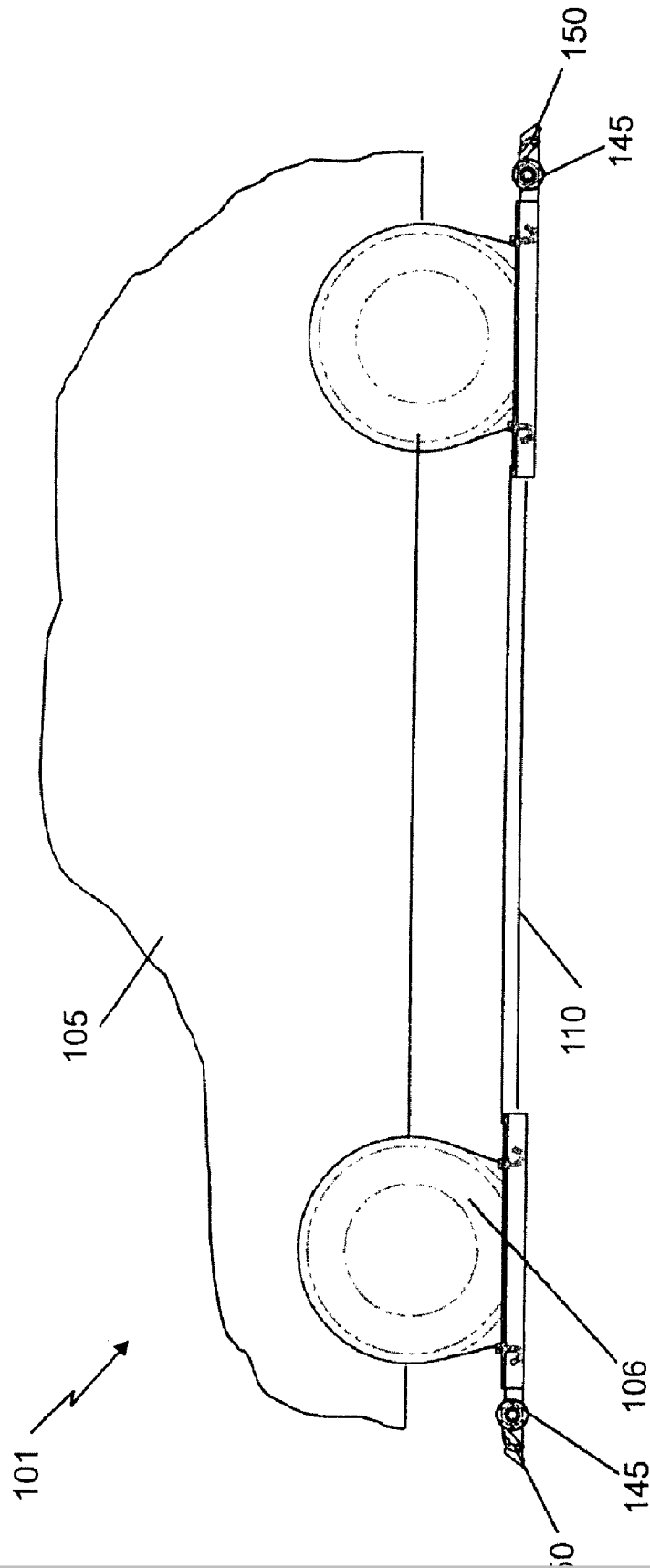
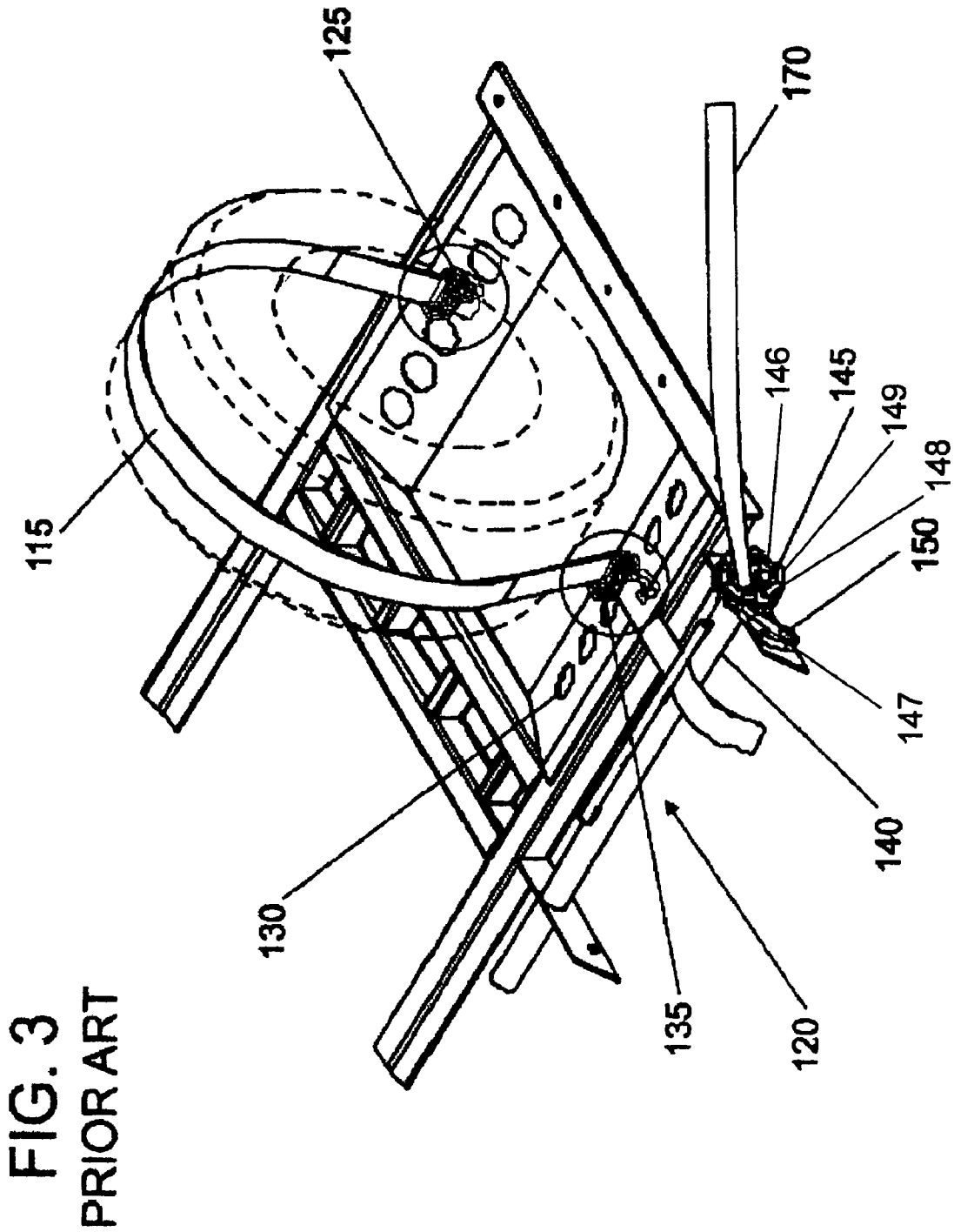

FIG. 2  
PRIOR ART





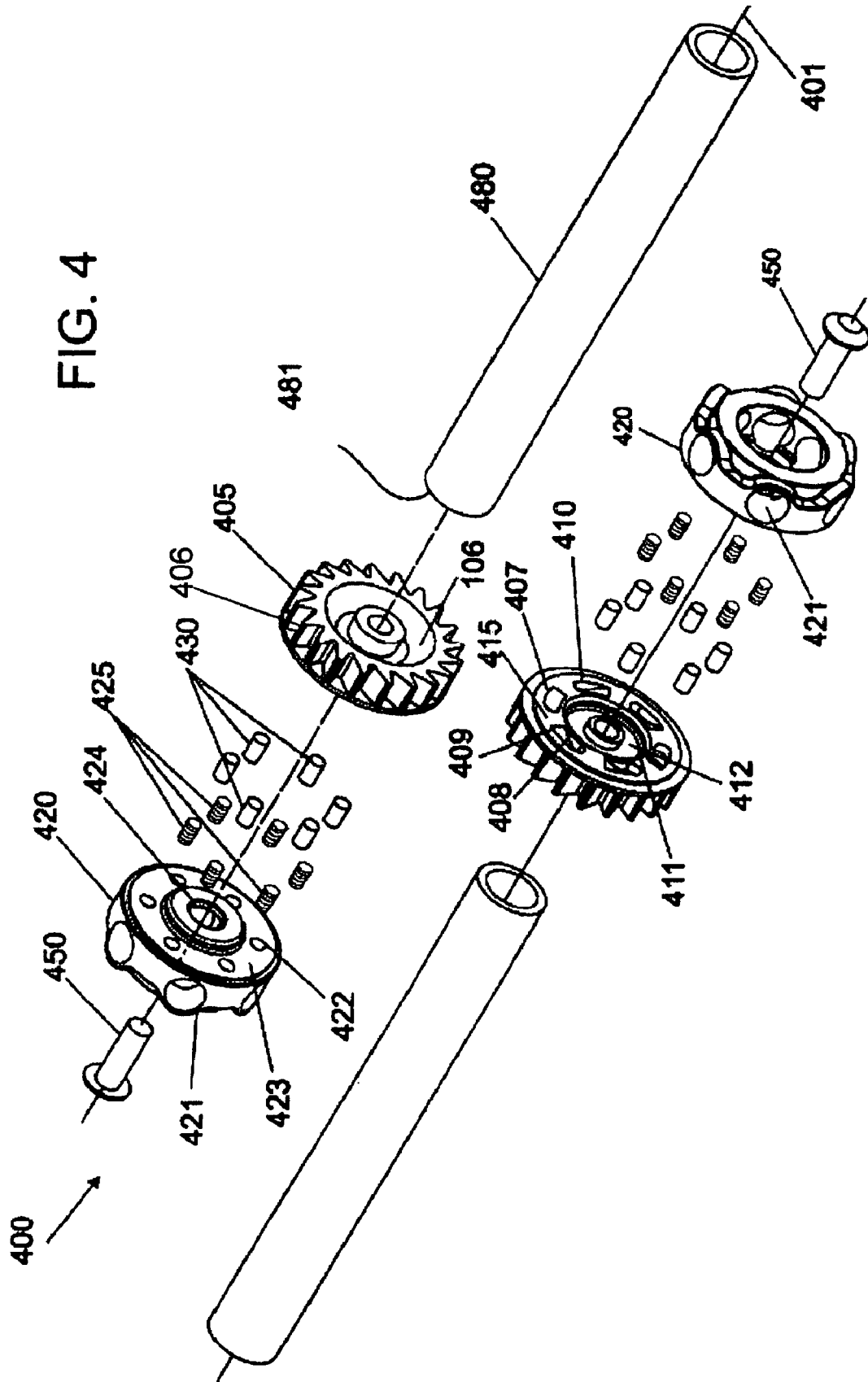

FIG. 4

# Explore Litigation Insights

Docket Alarm provides insights to develop a more informed litigation strategy and the peace of mind of knowing you're on top of things.

## Real-Time Litigation Alerts



Keep your litigation team up-to-date with **real-time alerts** and advanced team management tools built for the enterprise, all while greatly reducing PACER spend.

Our comprehensive service means we can handle Federal, State, and Administrative courts across the country.

## Advanced Docket Research



With over 230 million records, Docket Alarm's cloud-native docket research platform finds what other services can't. Coverage includes Federal, State, plus PTAB, TTAB, ITC and NLRB decisions, all in one place.

Identify arguments that have been successful in the past with full text, pinpoint searching. Link to case law cited within any court document via Fastcase.

## Analytics At Your Fingertips



Learn what happened the last time a particular judge, opposing counsel or company faced cases similar to yours.

Advanced out-of-the-box PTAB and TTAB analytics are always at your fingertips.

## API

Docket Alarm offers a powerful API (application programming interface) to developers that want to integrate case filings into their apps.

## LAW FIRMS

Build custom dashboards for your attorneys and clients with live data direct from the court.

Automate many repetitive legal tasks like conflict checks, document management, and marketing.

## FINANCIAL INSTITUTIONS

Litigation and bankruptcy checks for companies and debtors.

## E-DISCOVERY AND LEGAL VENDORS

Sync your system to PACER to automate legal marketing.