



US006824121B2

(12) **United States Patent**
Boice

(10) **Patent No.:** **US 6,824,121 B2**
(45) **Date of Patent:** **Nov. 30, 2004**

(54) **WHEEL SECURING DEVICE**

6,481,692 B1 * 11/2002 King 254/219
6,641,116 B1 * 11/2003 Huang 254/218

(76) Inventor: **Arthur D. Boice**, 222 Old Kings Hwy.,
Lake Katrine, NY (US) 12449

* cited by examiner

(*) Notice: Subject to any disclaimer, the term of this
patent is extended or adjusted under 35
U.S.C. 154(b) by 0 days.

Primary Examiner—Emmanuel Marcelo

(57) **ABSTRACT**

A wheel securing device is utilized with a wheel cradle of a
automobile dolly for securing an automobile wheel towing
an automobile. The wheel securing device includes a frame,
a shaft mounted to rotate in the frame. The shaft extends
beyond the frame and the shaft has a slot through it within
the frame. A ratchet gear is mounted on the shaft outside and
adjacent to the frame. A latch is mounted to rotate on the
frame to engage the ratchet gear to permit rotation of the
ratchet gear and the shaft in only one direction. A web
assembly is utilized for mounting on the automobile wheel.
The web assembly is connected to the shaft at the slot. A
drive pulley is mounted on the shaft and the drive pulley has
a nut extending from it on the side of the drive pulley
opposite from the side facing the ratchet gear for tightening
the web assembly on the automobile wheel. By placing the
ratchet gear and latch on the outside of the frame and
extending the shaft, the drive wheel can be placed outside
the cradle for easy operation.

(21) Appl. No.: **10/351,015**

(22) Filed: **Jan. 25, 2003**

(65) **Prior Publication Data**

US 2004/0144964 A1 Jul. 29, 2004

(51) **Int. Cl.**⁷ **B66F 3/00**

(52) **U.S. Cl.** **254/223; 24/69 ST**

(58) **Field of Search** **254/222, 223,**
254/213; 24/69 ST, 68 CD

(56) **References Cited**

U.S. PATENT DOCUMENTS

- 2,416,708 A * 3/1947 Moore 254/223
- 2,738,204 A * 3/1956 Ibey 410/36
- 5,156,506 A * 10/1992 Bailey 410/100
- 6,101,927 A * 8/2000 Kurmlavage 99/343
- 6,106,216 A * 8/2000 Hogan 414/678

3 Claims, 4 Drawing Sheets

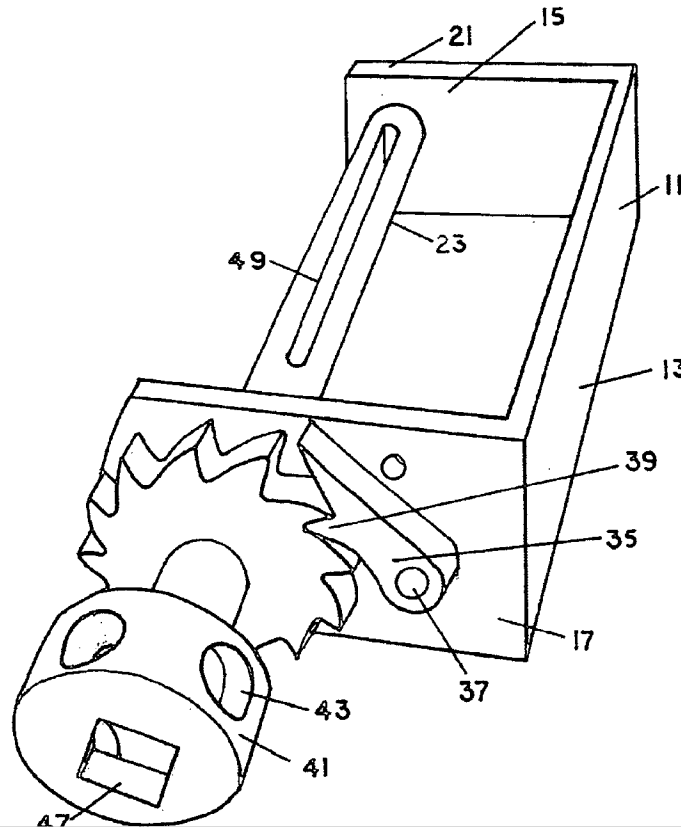

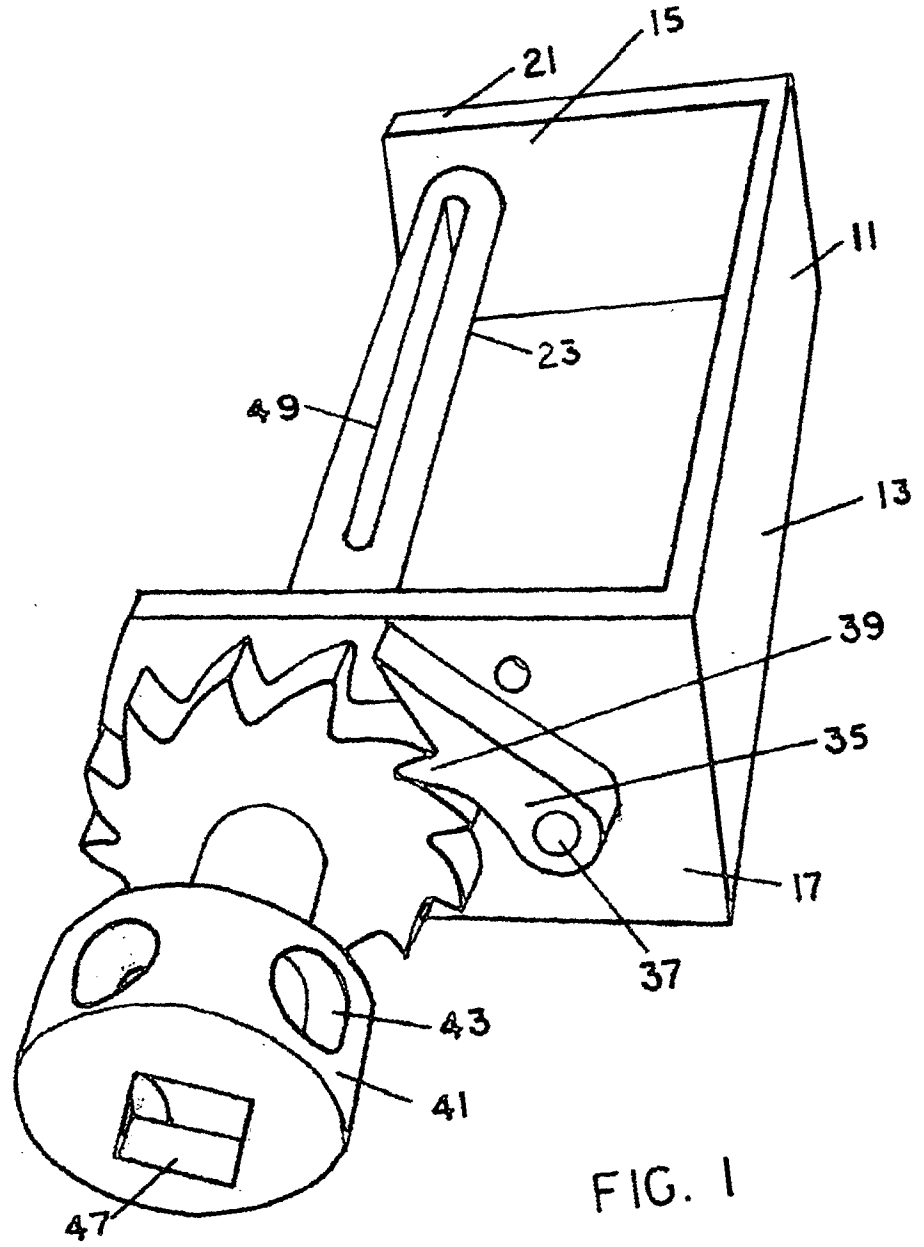

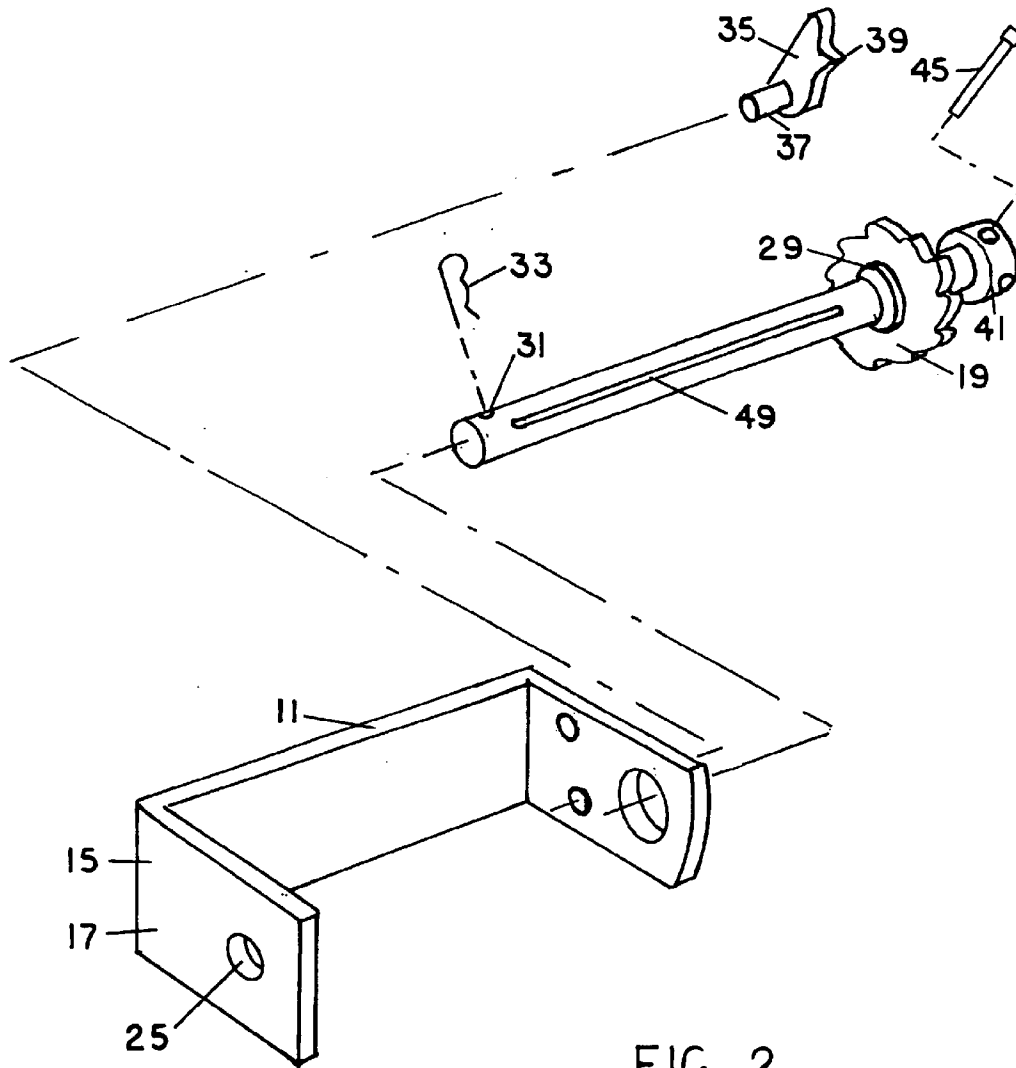

FIG. 2

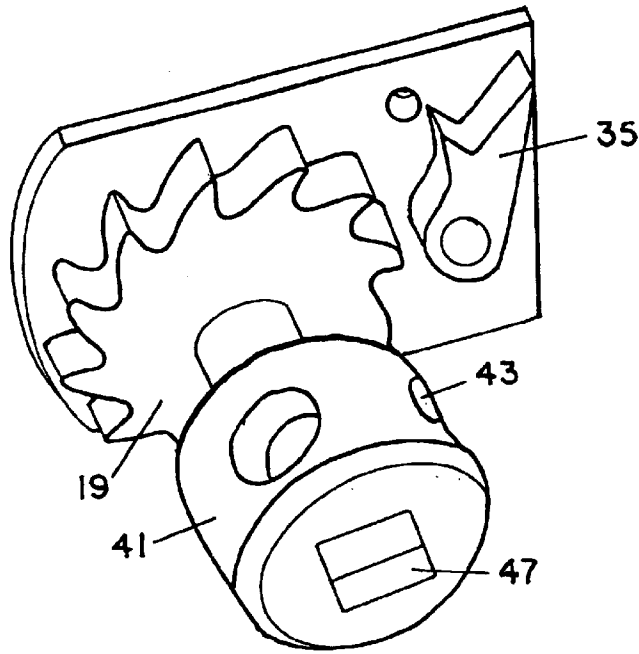

FIG. 3

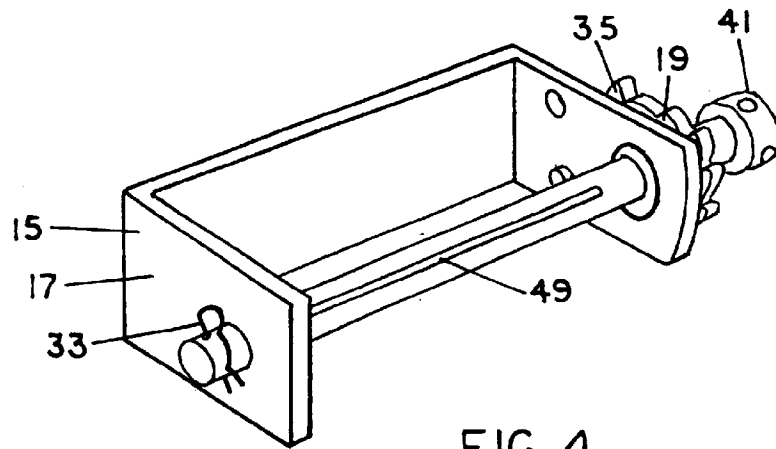

FIG. 4

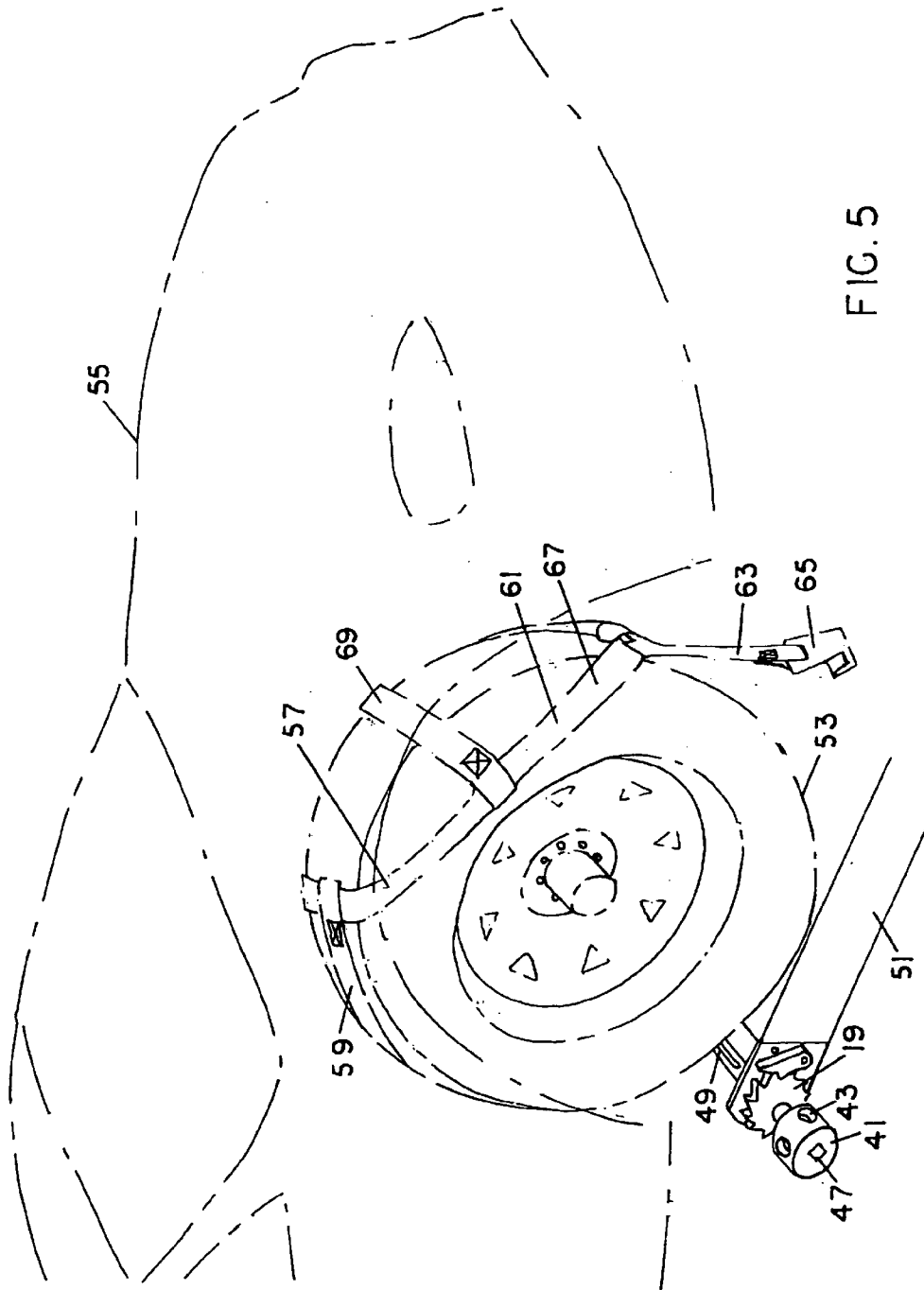

FIG. 5

Explore Litigation Insights

Docket Alarm provides insights to develop a more informed litigation strategy and the peace of mind of knowing you're on top of things.

Real-Time Litigation Alerts



Keep your litigation team up-to-date with **real-time alerts** and advanced team management tools built for the enterprise, all while greatly reducing PACER spend.

Our comprehensive service means we can handle Federal, State, and Administrative courts across the country.

Advanced Docket Research



With over 230 million records, Docket Alarm's cloud-native docket research platform finds what other services can't. Coverage includes Federal, State, plus PTAB, TTAB, ITC and NLRB decisions, all in one place.

Identify arguments that have been successful in the past with full text, pinpoint searching. Link to case law cited within any court document via Fastcase.

Analytics At Your Fingertips



Learn what happened the last time a particular judge, opposing counsel or company faced cases similar to yours.

Advanced out-of-the-box PTAB and TTAB analytics are always at your fingertips.

API

Docket Alarm offers a powerful API (application programming interface) to developers that want to integrate case filings into their apps.

LAW FIRMS

Build custom dashboards for your attorneys and clients with live data direct from the court.

Automate many repetitive legal tasks like conflict checks, document management, and marketing.

FINANCIAL INSTITUTIONS

Litigation and bankruptcy checks for companies and debtors.

E-DISCOVERY AND LEGAL VENDORS

Sync your system to PACER to automate legal marketing.