

(12) **United States Patent**
Proehl et al.

(10) **Patent No.:** **US 6,690,391 B1**
(45) **Date of Patent:** **Feb. 10, 2004**

(54) **MODAL DISPLAY, SMOOTH SCROLL GRAPHIC USER INTERFACE AND REMOTE COMMAND DEVICE SUITABLE FOR EFFICIENT NAVIGATION AND SELECTION OF DYNAMIC DATA/OPTIONS PRESENTED WITHIN AN AUDIO/VISUAL SYSTEM**

6,020,930 A 2/2000 Legrand 348/569
6,028,600 A 2/2000 Rosin et al. 345/327
6,034,677 A 3/2000 Noguchi et al. 345/327
6,072,483 A 6/2000 Rosin et al. 345/335
6,128,009 A * 10/2000 Ohkura et al. 725/46
6,445,398 B1 * 9/2002 Gerba et al. 345/721
6,452,609 B1 * 9/2002 Katinsky et al. 345/716

(75) Inventors: **Andrew M. Proehl**, San Francisco, CA (US); **Jan-Christoph Zoels**, Brooklyn, NY (US); **Anne Hyan Jin Kim**, Douglaston, NY (US); **Yutaka Hasegawa**, Tokyo (JP)

OTHER PUBLICATIONS

Toshiba, Owner's Manual, 1998, Toshiba Corporation, pp. 1-3.*
Mitsubishi, Installation and Operation Manual, 1990, Mitsubishi Corporation, pp. 1-2.*

(73) Assignees: **Sony Corporation**, Tokyo (JP); **Sony Electronics, Inc.**, Park Ridge, NJ (US)

* cited by examiner

(*) Notice: Subject to any disclaimer, the term of this patent is extended or adjusted under 35 U.S.C. 154(b) by 411 days.

Primary Examiner—Kristine Kincaid
Assistant Examiner—Le V Nguyen
(74) *Attorney, Agent, or Firm*—Miller Patent Services; Jerry A. Miller

(21) Appl. No.: **09/615,871**

(57) **ABSTRACT**

(22) Filed: **Jul. 13, 2000**

The efficient and intuitive presentation, navigation, and selection of AV information in a graphical user interface (GUI) displayed on a display apparatus of an AV system. Related AV information is organized as items within lists that correspond to various navigable fields of a status bar of the GUI during the GUI interactive mode. A highlighted navigable field of the status bar displays its list of related AV information and the items of the list are scrolled through the navigable field by a user causing a scrolling cylinder of a navigation and selection device to move in a scroll. A different field of the status bar may be selected by the user moving the scrolling cylinder in a lateral movement. Activation of the selection mechanism of the navigation and selection device will cause an AV device to be controlled in accordance with the currently displayed AV options.

(51) **Int. Cl.**⁷ **G09G 5/00**
(52) **U.S. Cl.** **345/720; 725/40; 725/56**
(58) **Field of Search** **345/719-722, 345/853-855, 727-729, 830, 841-843, 810; 725/37-61**

(56) **References Cited**

U.S. PATENT DOCUMENTS

5,530,455 A * 6/1996 Gillick et al. 345/163
5,793,366 A 8/1998 Mano et al. 345/329
5,903,314 A 5/1999 Nijjima et al. 348/564
5,956,035 A 9/1999 Sciammarella et al. 345/353
5,973,682 A 10/1999 Saib et al. 345/327
6,005,562 A * 12/1999 Shiga et al. 345/721

28 Claims, 19 Drawing Sheets

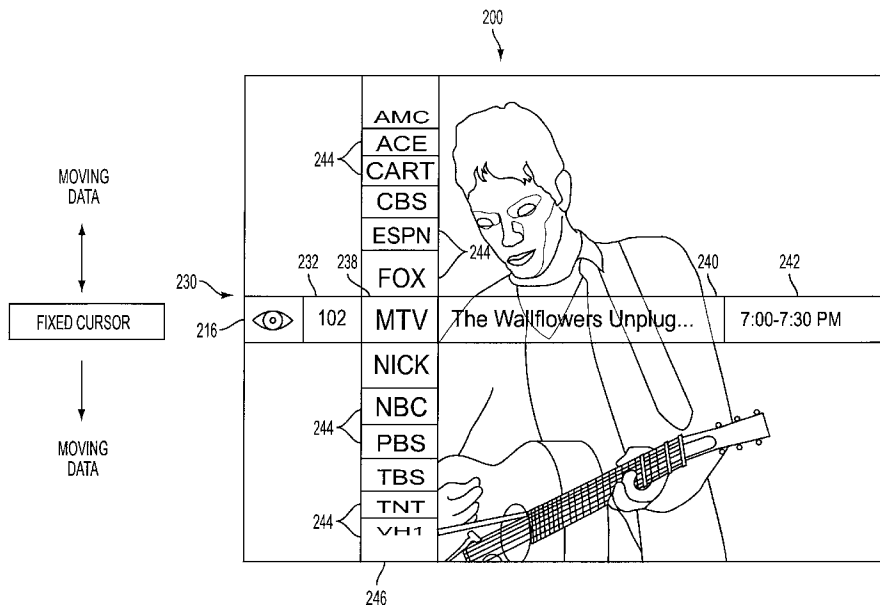

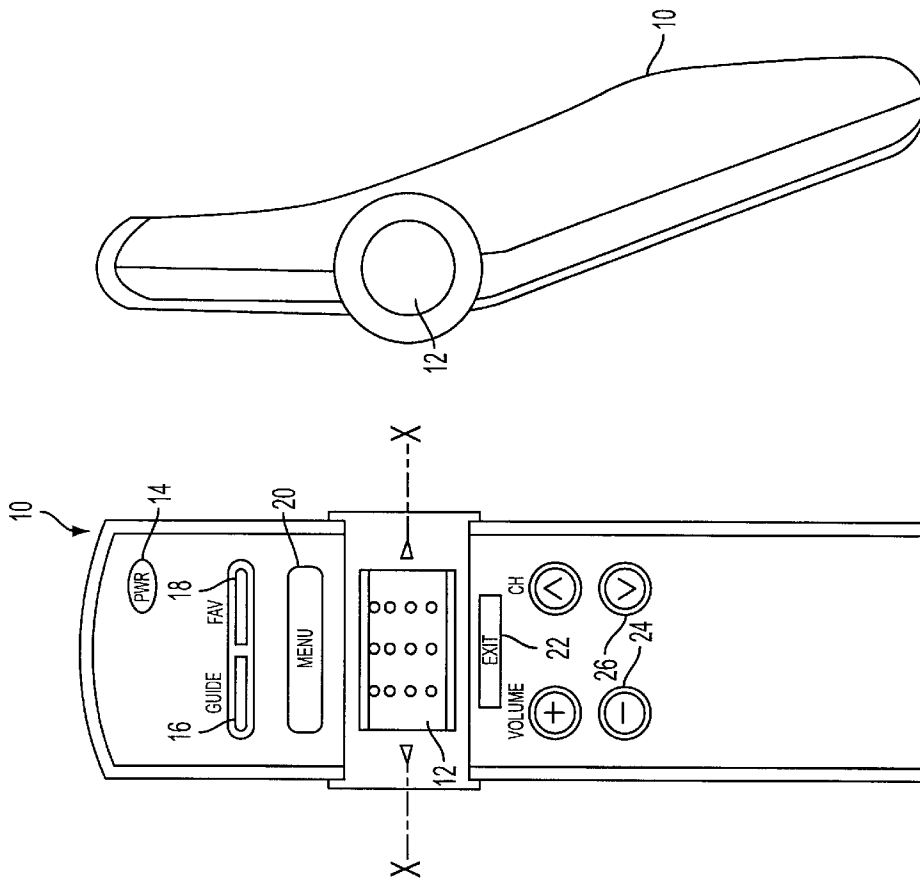

FIG. 1B

FIG. 1A

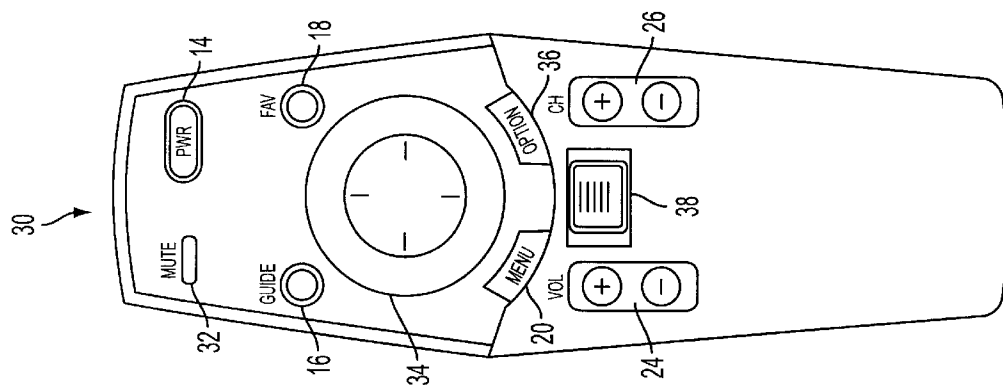

FIG. 2A

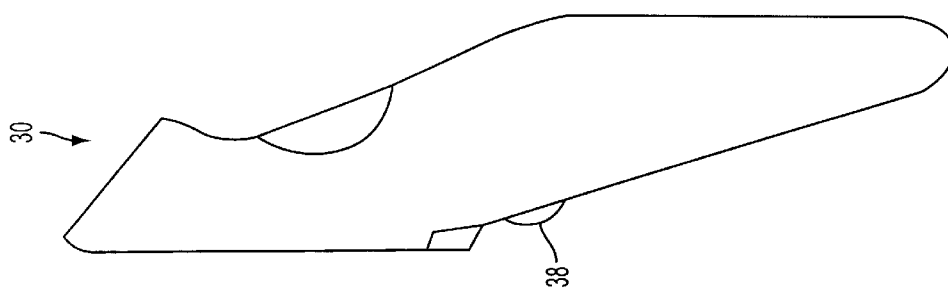

FIG. 2B

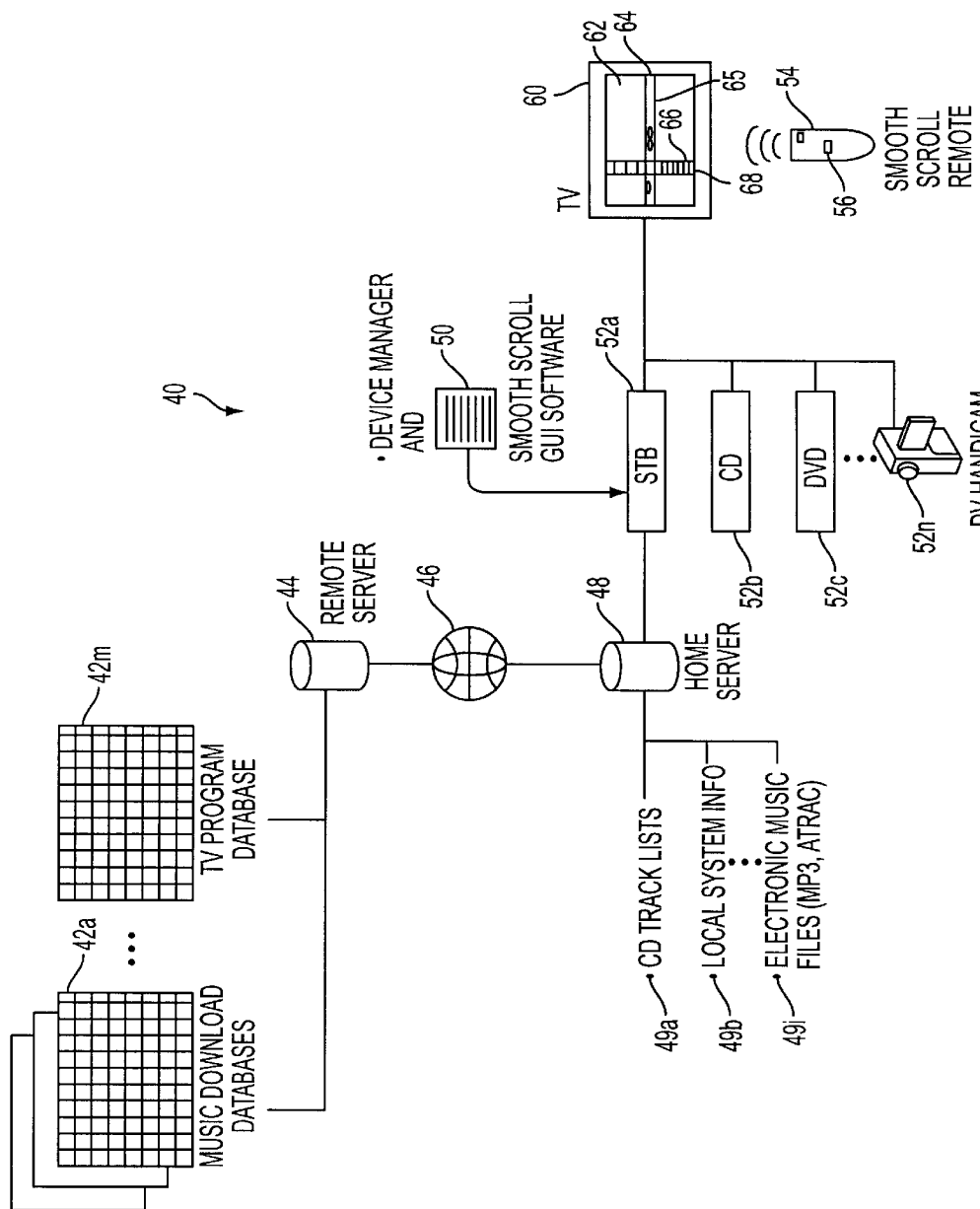

FIG. 3

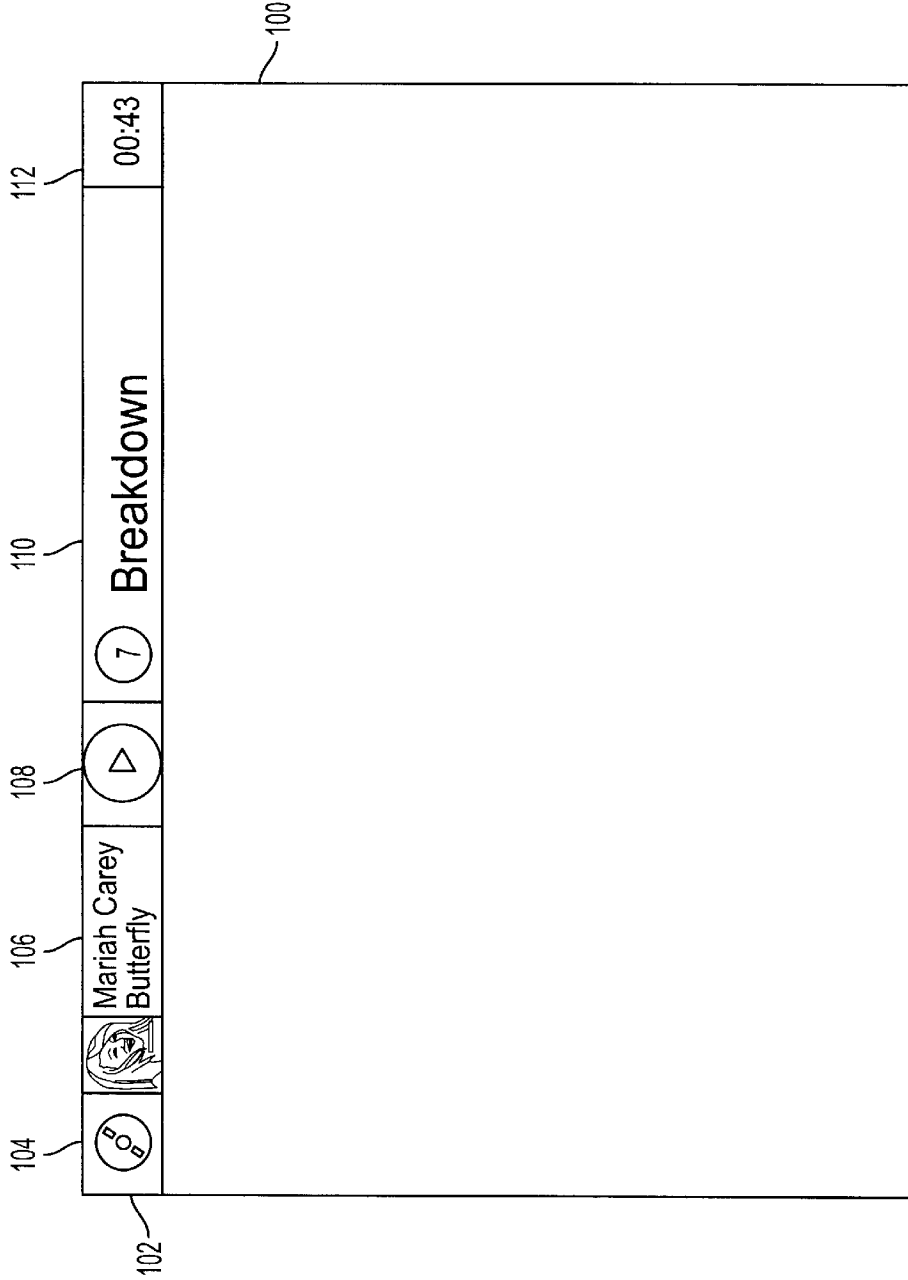

FIG. 4

Explore Litigation Insights

Docket Alarm provides insights to develop a more informed litigation strategy and the peace of mind of knowing you're on top of things.

Real-Time Litigation Alerts



Keep your litigation team up-to-date with **real-time alerts** and advanced team management tools built for the enterprise, all while greatly reducing PACER spend.

Our comprehensive service means we can handle Federal, State, and Administrative courts across the country.

Advanced Docket Research



With over 230 million records, Docket Alarm's cloud-native docket research platform finds what other services can't. Coverage includes Federal, State, plus PTAB, TTAB, ITC and NLRB decisions, all in one place.

Identify arguments that have been successful in the past with full text, pinpoint searching. Link to case law cited within any court document via Fastcase.

Analytics At Your Fingertips



Learn what happened the last time a particular judge, opposing counsel or company faced cases similar to yours.

Advanced out-of-the-box PTAB and TTAB analytics are always at your fingertips.

API

Docket Alarm offers a powerful API (application programming interface) to developers that want to integrate case filings into their apps.

LAW FIRMS

Build custom dashboards for your attorneys and clients with live data direct from the court.

Automate many repetitive legal tasks like conflict checks, document management, and marketing.

FINANCIAL INSTITUTIONS

Litigation and bankruptcy checks for companies and debtors.

E-DISCOVERY AND LEGAL VENDORS

Sync your system to PACER to automate legal marketing.