



US 20050006432A1

(19) **United States**

(12) **Patent Application Publication** (10) **Pub. No.: US 2005/0006432 A1**

Racenet et al.

(43) **Pub. Date: Jan. 13, 2005**

(54) **SURGICAL STAPLING DEVICE**

(52) **U.S. Cl. 227/176.1; 227/19**

(76) **Inventors: David C. Racenet, Litchfield, CT (US); Ralph Stearns, Bozrah, CT (US); John W. Beardsley, Hamden, CT (US); Philip Roy, Hamden, CT (US); Lee Ann Olson, Wallingford, CT (US)**

(57) **ABSTRACT**

A surgical device is disclosed which includes a handle portion, a central body portion and a SULU. The SULU includes a proximal body portion, an intermediate pivot member and a tool assembly. The intermediate pivot member is pivotally secured to the proximal body portion about a first pivot axis and the tool assembly is pivotally secured to the intermediate pivot member about a second pivot axis which is orthogonal to the first pivot axis. The SULU includes a plurality of articulation links which are operably connected to the tool assembly by non-rigid links. The articulation links are adapted to releasably engage articulation links positioned in the central body portion. The body portion articulation links are connected to an articulation actuator which is supported for omni-directional movement to effect articulation of the tool assembly about the first and second axes. The handle portion includes a spindle and barrel assembly drive mechanism for advancing and retracting a drive member positioned in the tool assembly. In one embodiment, the tool assembly includes a cartridge assembly having a plurality of staples and an anvil assembly.

Correspondence Address:

Paul R. Audet, Esq.
U.S. Surgical
A Division of Tyco Healthcare Group, LP
150 Glover Avenue
Norwalk, CT 06856 (US)

(21) **Appl. No.: 10/871,342**

(22) **Filed: Jun. 17, 2004**

Related U.S. Application Data

(60) **Provisional application No. 60/479,379, filed on Jun. 17, 2003.**

Publication Classification

(51) **Int. Cl.⁷ A61B 17/04**

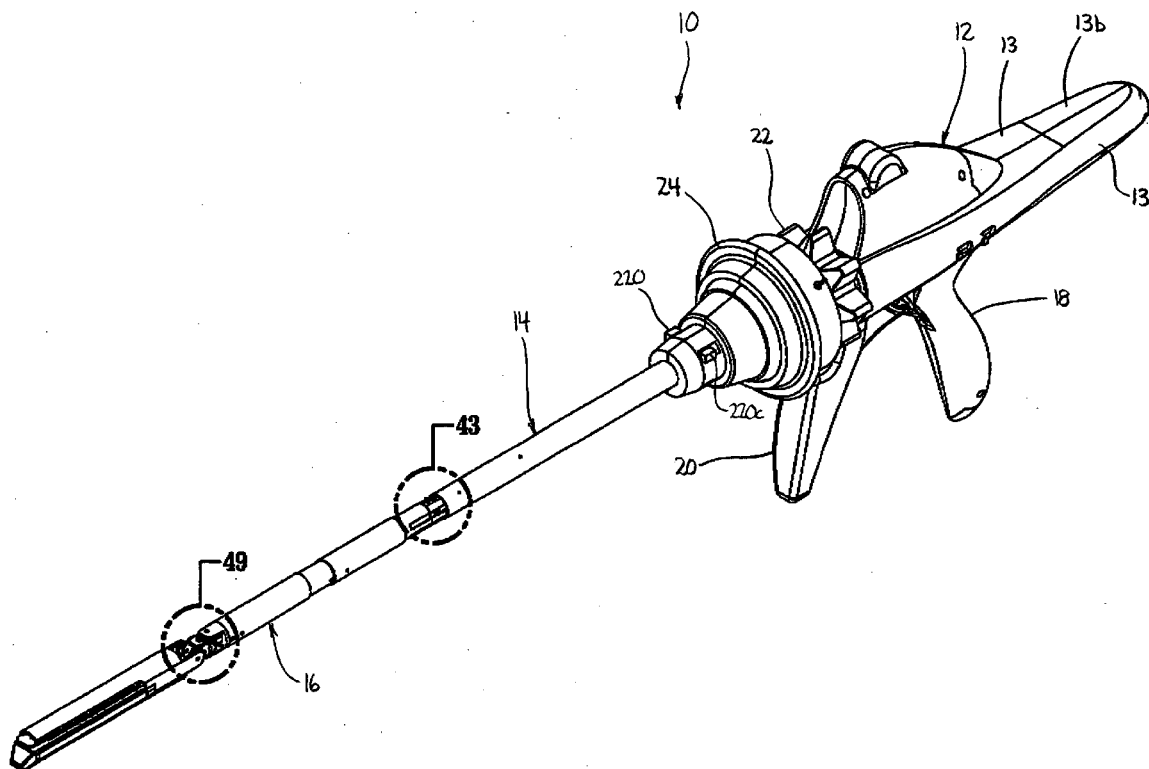

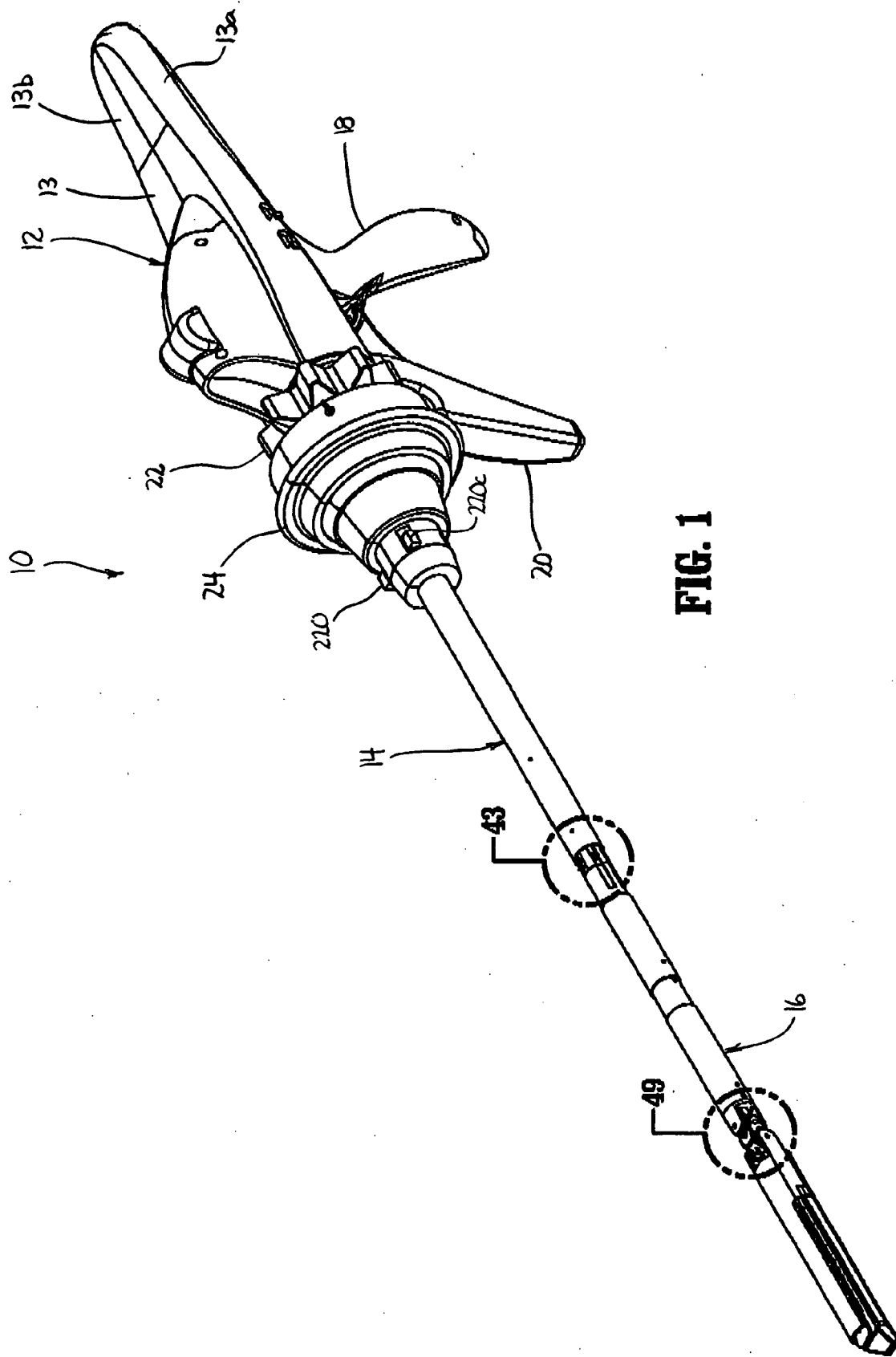

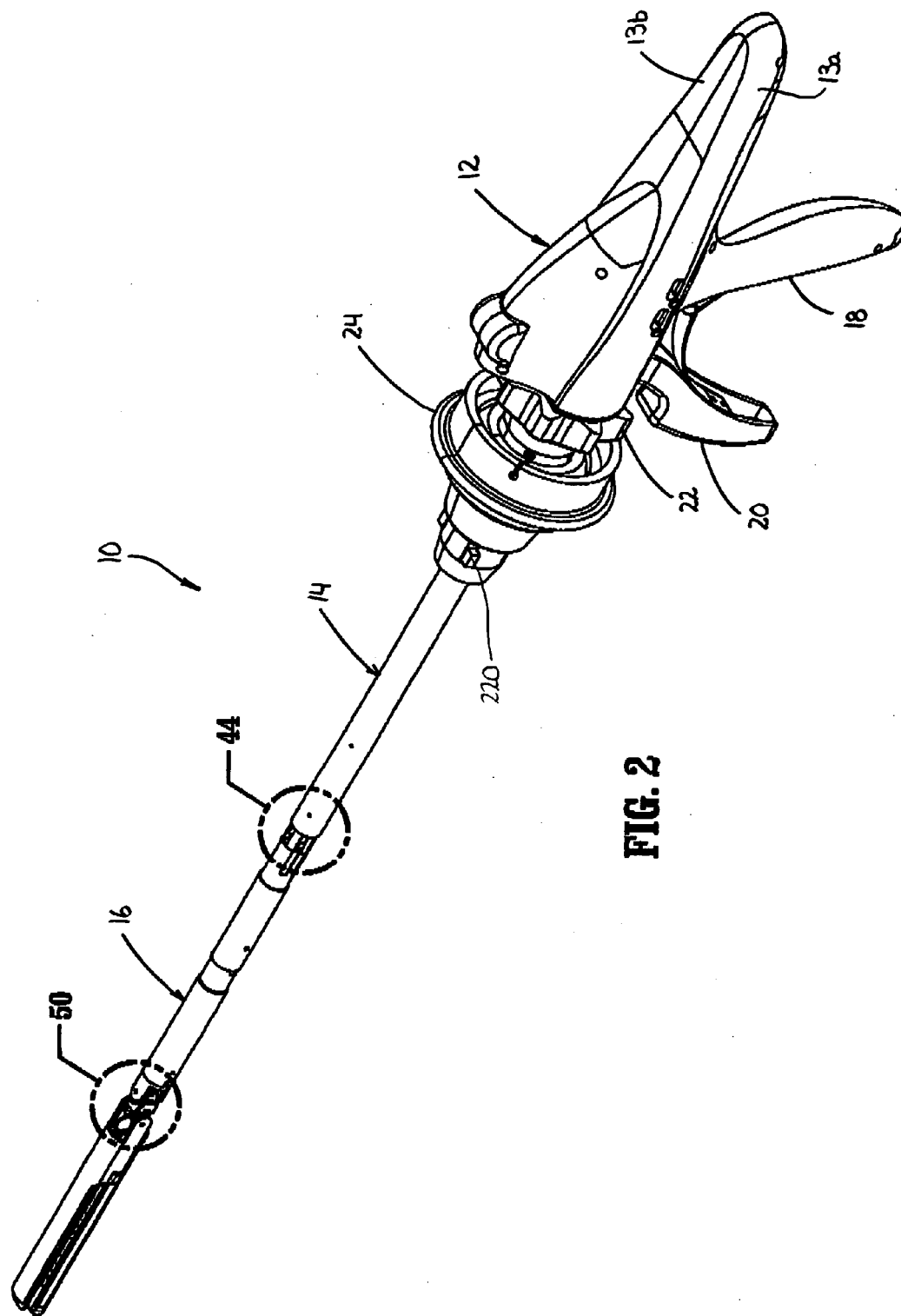

FIG. 2

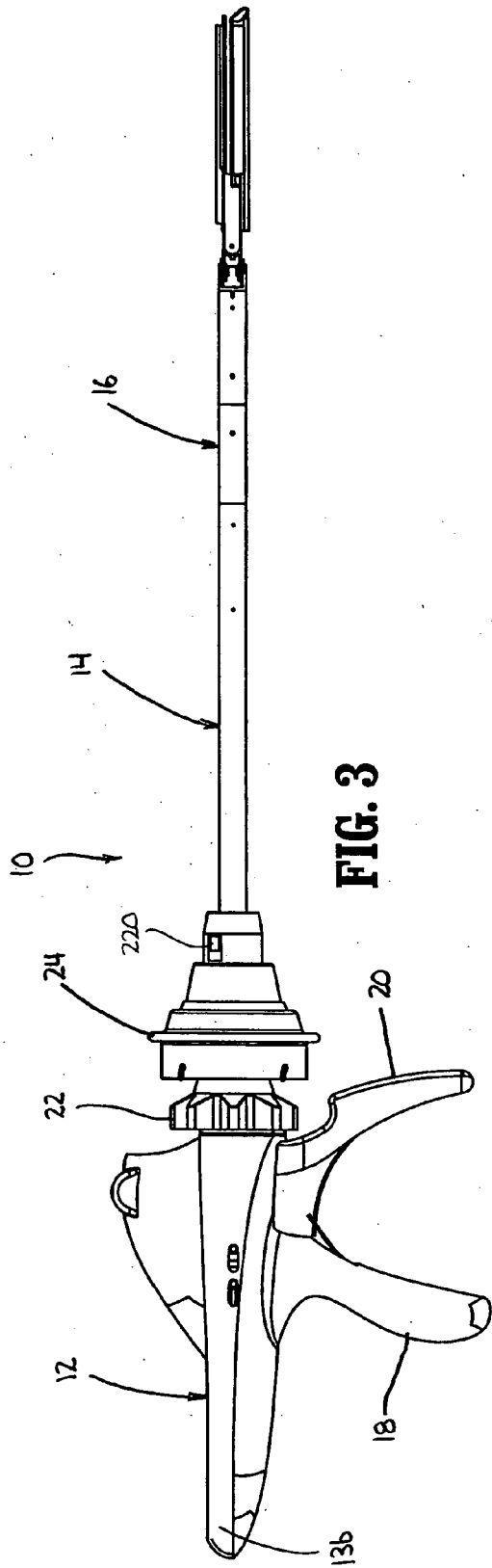

FIG. 3

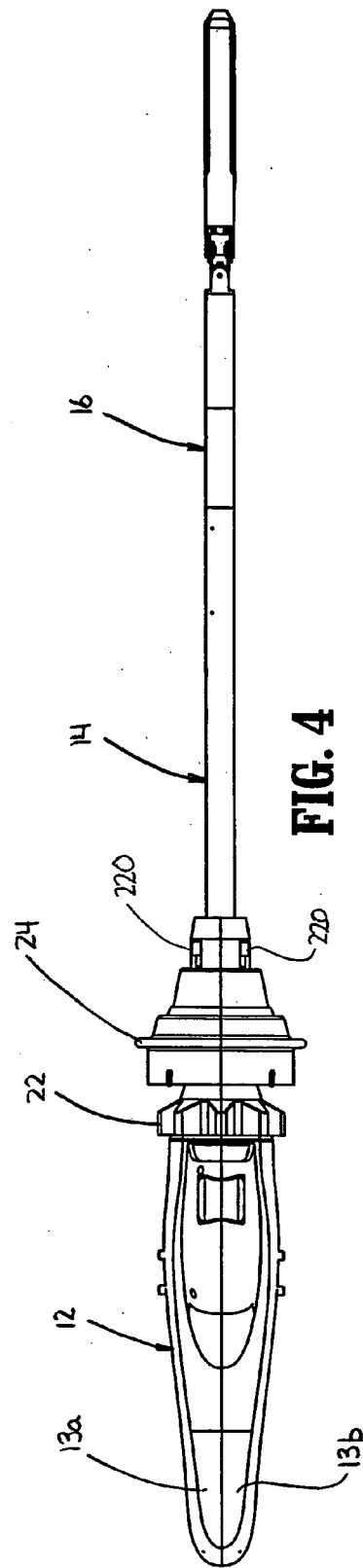

FIG. 4

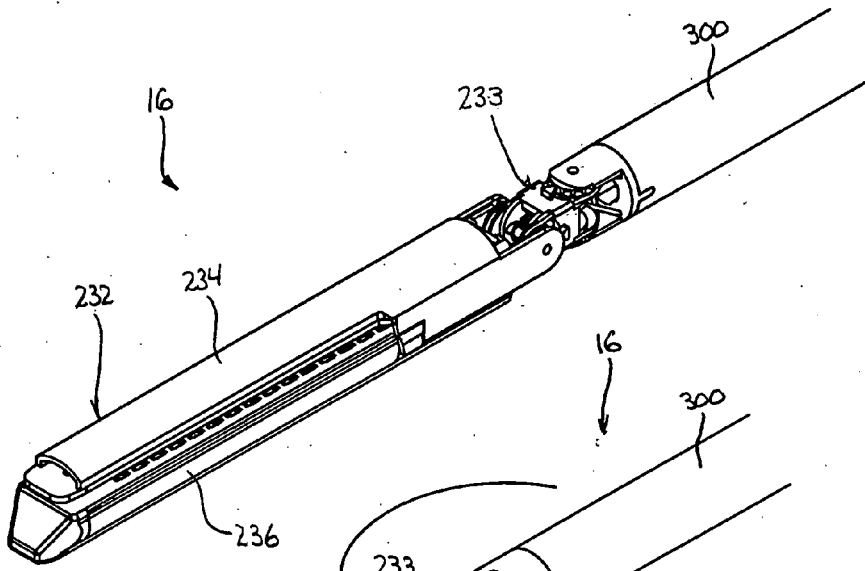

FIG. 5

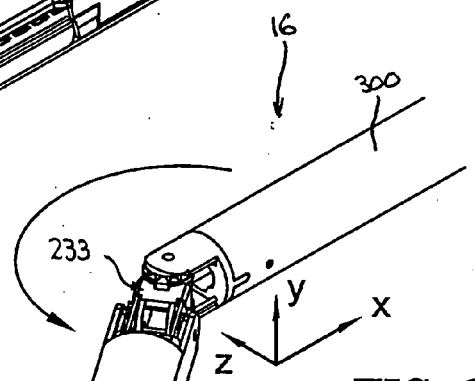

FIG. 6

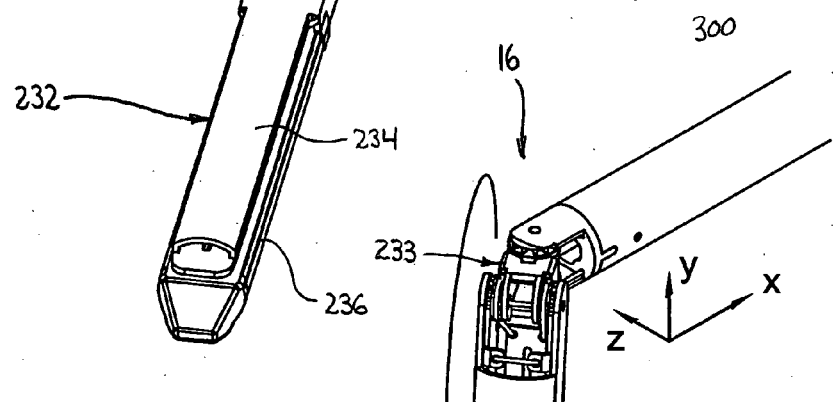

FIG. 7

Explore Litigation Insights

Docket Alarm provides insights to develop a more informed litigation strategy and the peace of mind of knowing you're on top of things.

Real-Time Litigation Alerts



Keep your litigation team up-to-date with **real-time alerts** and advanced team management tools built for the enterprise, all while greatly reducing PACER spend.

Our comprehensive service means we can handle Federal, State, and Administrative courts across the country.

Advanced Docket Research



With over 230 million records, Docket Alarm's cloud-native docket research platform finds what other services can't. Coverage includes Federal, State, plus PTAB, TTAB, ITC and NLRB decisions, all in one place.

Identify arguments that have been successful in the past with full text, pinpoint searching. Link to case law cited within any court document via Fastcase.

Analytics At Your Fingertips



Learn what happened the last time a particular judge, opposing counsel or company faced cases similar to yours.

Advanced out-of-the-box PTAB and TTAB analytics are always at your fingertips.

API

Docket Alarm offers a powerful API (application programming interface) to developers that want to integrate case filings into their apps.

LAW FIRMS

Build custom dashboards for your attorneys and clients with live data direct from the court.

Automate many repetitive legal tasks like conflict checks, document management, and marketing.

FINANCIAL INSTITUTIONS

Litigation and bankruptcy checks for companies and debtors.

E-DISCOVERY AND LEGAL VENDORS

Sync your system to PACER to automate legal marketing.