

EXHIBIT F



(12) **United States Patent**
Dannat et al.

(10) **Patent No.:** **US 9,691,275 B2**
 (45) **Date of Patent:** **Jun. 27, 2017**

(54) **ADJUSTING VEHICLE TIMING IN A TRANSPORTATION NETWORK**

(71) Applicant: **INTERNATIONAL BUSINESS MACHINES CORPORATION**, Armonk, NY (US)

(72) Inventors: **Tobias Ephraim Dannat**, Zürich (CH); **Andreas Kuehmichel**, Mainz (DE); **Tim Scheideler**, Helsinki (FI); **Matthias Seul**, Kassel (DE); **Thomas Allen Snellgrove**, Littleton, MA (US)

(73) Assignee: **International Business Machines Corporation**, Armonk, NY (US)

(*) Notice: Subject to any disclaimer, the term of this patent is extended or adjusted under 35 U.S.C. 154(b) by 0 days.

(56) **References Cited**

U.S. PATENT DOCUMENTS

8,315,802 B2	11/2012	Brown	
8,825,350 B1 *	9/2014	Robinson G08G 1/0116
			340/909
2008/0094250 A1 *	4/2008	Myr G08G 1/04
			340/909
2009/0077099 A1 *	3/2009	Haustein G06F 9/5011
2009/0174573 A1 *	7/2009	Smith G08G 1/0962
			340/905
2010/0280748 A1	11/2010	Munding et al.	
2012/0221230 A1 *	8/2012	Reilhac G08G 1/096716
			701/117
2013/0116916 A1 *	5/2013	Kickbusch B61L 27/0016
			701/118
2013/0158846 A1	6/2013	Zhang	
2014/0025294 A1	1/2014	Boss et al.	

(Continued)

FOREIGN PATENT DOCUMENTS

WO	WO2007067841 A2	6/2007
WO	WO2014026956 A1	2/2014

(21) Appl. No.: **14/934,684**

(22) Filed: **Nov. 6, 2015**

(65) **Prior Publication Data**

US 2017/0132914 A1 May 11, 2017

(51) **Int. Cl.**
G08G 1/00 (2006.01)
B60K 35/00 (2006.01)

(52) **U.S. Cl.**
 CPC **G08G 1/00** (2013.01); **B60K 35/00** (2013.01)

(58) **Field of Classification Search**
 CPC G08G 1/00; G08G 9/00; G08G 1/0962; G08G 1/0116; G08G 1/096716; G08G 1/04; B61L 27/0016; G06Q 10/06311; G06F 9/5011

See application file for complete search history.

OTHER PUBLICATIONS

Partha Chakroborty; Optimal Routing and Scheduling in Transportation: Using Genetic Algorithm to Solve Difficult Optimization Problems; 2004.

(Continued)

Primary Examiner — Yuri Kan
 (74) Attorney, Agent, or Firm — Daniel R. Simek; George S. Blasiak; Heslin, Rothenberg, Farley & Mesiti, PC

(57) **ABSTRACT**

Methods, computer program products, and systems are presented. The methods include, for instance: obtaining passenger information of one or more passenger traveling within a transportation network; and providing one or more output based on a processing of the passenger information.

18 Claims, 22 Drawing Sheets

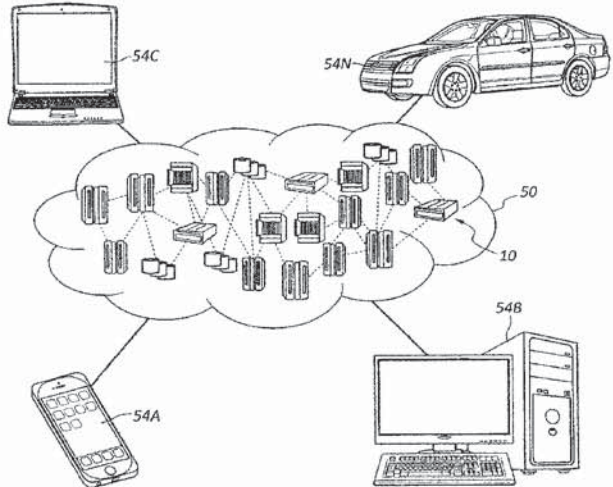

US 9,691,275 B2

Page 2

(56)

References Cited

U.S. PATENT DOCUMENTS

2014/0136025 A1* 5/2014 Cooper G08G 9/00
701/2
2015/0262101 A1* 9/2015 Aoki G06Q 10/06311
705/7.13

OTHER PUBLICATIONS

Gunjal Sunil N. , Joshi Ajinkya V. , Gosavi Swapnil C. , Kshirsagar Vyanktesh B.; Dynamic Bus Timetable Using GPS; International Journal of Advanced Research in Computer Engineering & Technology (IJARCET); vol. 3 Issue 3, Mar. 2014.

S.R. Subramanya; Adaptive Bus Routing Heuristics for Improving Vehicle Utilization and Reducing Commuter Waiting Times; International Journal of Innovative Research in Computer and Communication Engineering; vol. 2, Issue 5, May 2014.

Mel, Peter; Grance, Timothy; The NIST Definition of Cloud Computing; NIST Special Publication 800-145; Sep. 2011.

T.E. Dannat, et al. "List of IBM Patents and/or Patent Applications Treated as Related," U.S. Appl. No. 15/582,909, filed May 1, 2017 . Dated: May 1, 2017.

T.E. Dannat, et al. "Adjusting Vehicle Timing in a Transportation Network," U.S. Appl. No. 15/582,909, filed May 1, 2017.

* cited by examiner

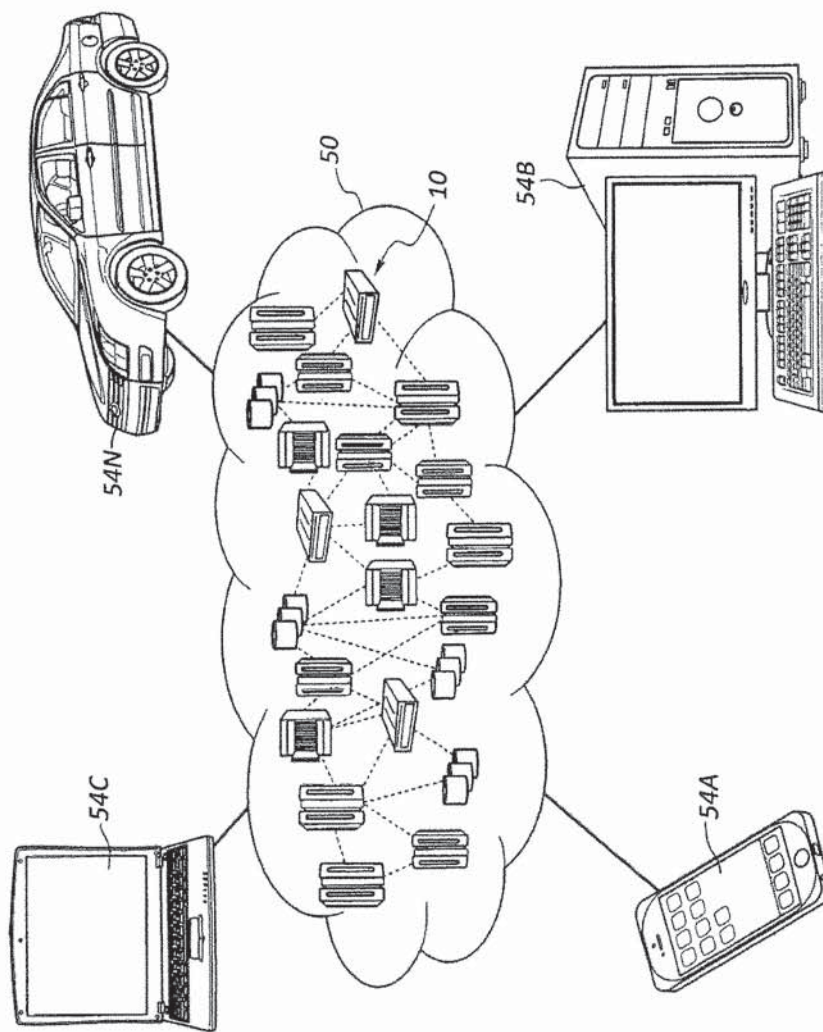

FIG. 1

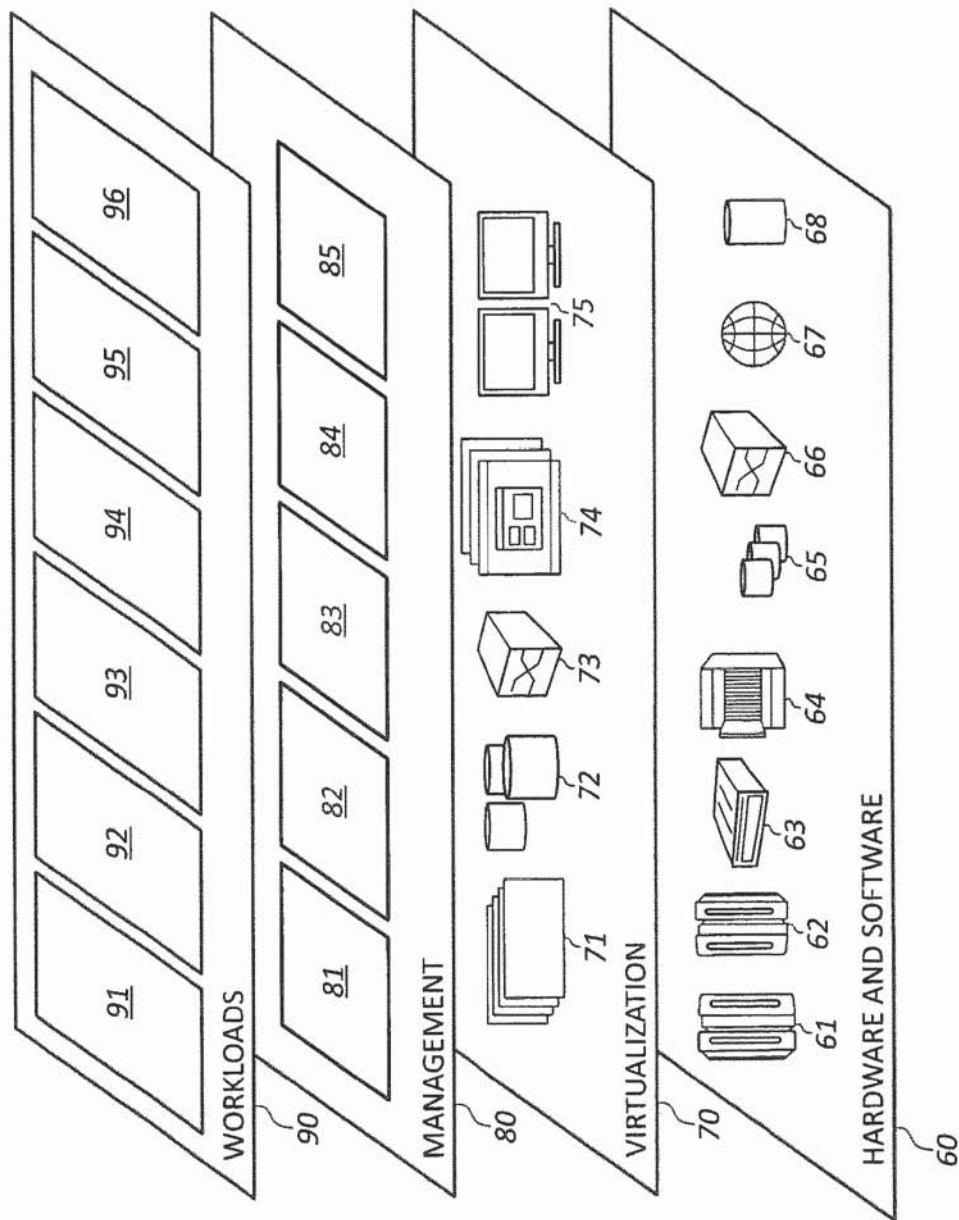

FIG. 2

Explore Litigation Insights

Docket Alarm provides insights to develop a more informed litigation strategy and the peace of mind of knowing you're on top of things.

Real-Time Litigation Alerts



Keep your litigation team up-to-date with **real-time alerts** and advanced team management tools built for the enterprise, all while greatly reducing PACER spend.

Our comprehensive service means we can handle Federal, State, and Administrative courts across the country.

Advanced Docket Research



With over 230 million records, Docket Alarm's cloud-native docket research platform finds what other services can't. Coverage includes Federal, State, plus PTAB, TTAB, ITC and NLRB decisions, all in one place.

Identify arguments that have been successful in the past with full text, pinpoint searching. Link to case law cited within any court document via Fastcase.

Analytics At Your Fingertips



Learn what happened the last time a particular judge, opposing counsel or company faced cases similar to yours.

Advanced out-of-the-box PTAB and TTAB analytics are always at your fingertips.

API

Docket Alarm offers a powerful API (application programming interface) to developers that want to integrate case filings into their apps.

LAW FIRMS

Build custom dashboards for your attorneys and clients with live data direct from the court.

Automate many repetitive legal tasks like conflict checks, document management, and marketing.

FINANCIAL INSTITUTIONS

Litigation and bankruptcy checks for companies and debtors.

E-DISCOVERY AND LEGAL VENDORS

Sync your system to PACER to automate legal marketing.